

# WD-22

## km 38+491,21

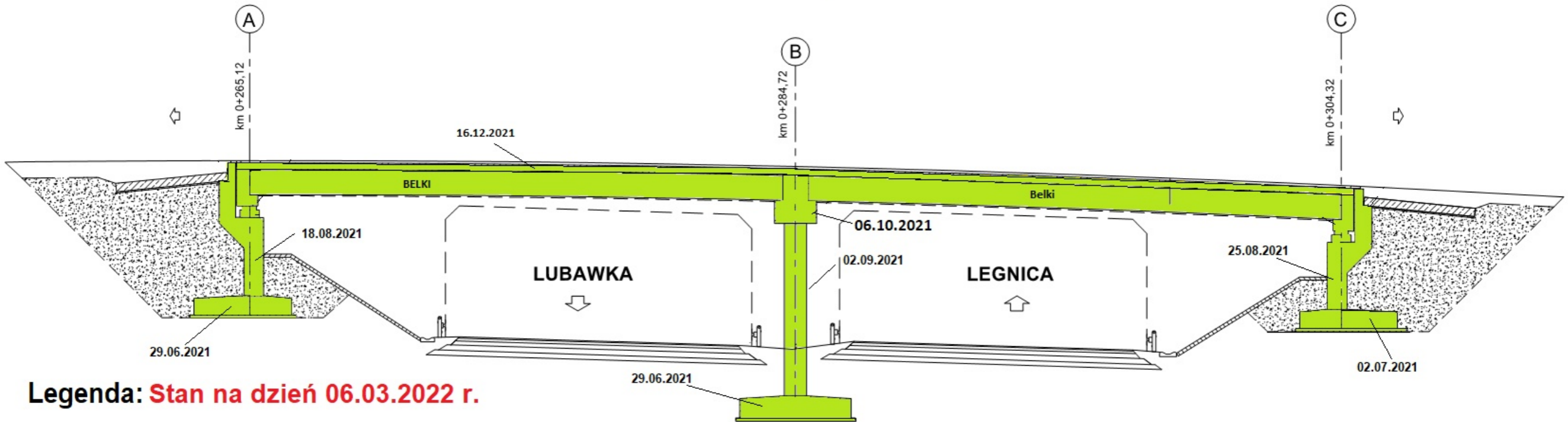

**Legenda: Stan na dzień 06.03.2022 r.**

- Roboty w trakcie wykonywania
- Roboty zakończone

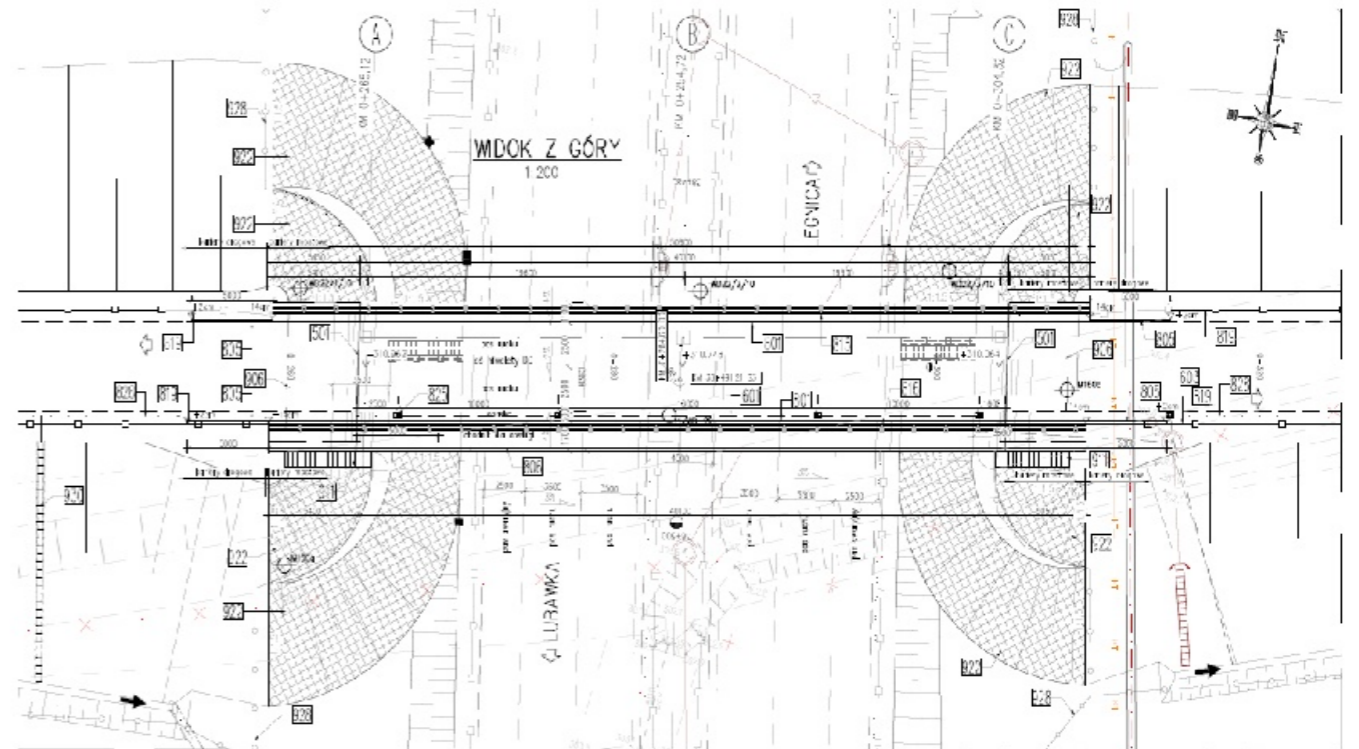
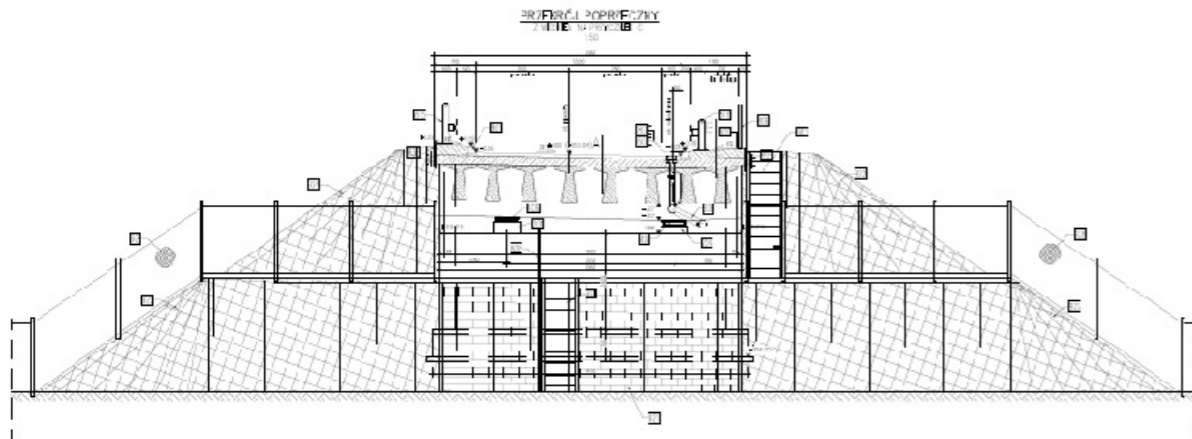

# WS-24

km 41+431,41

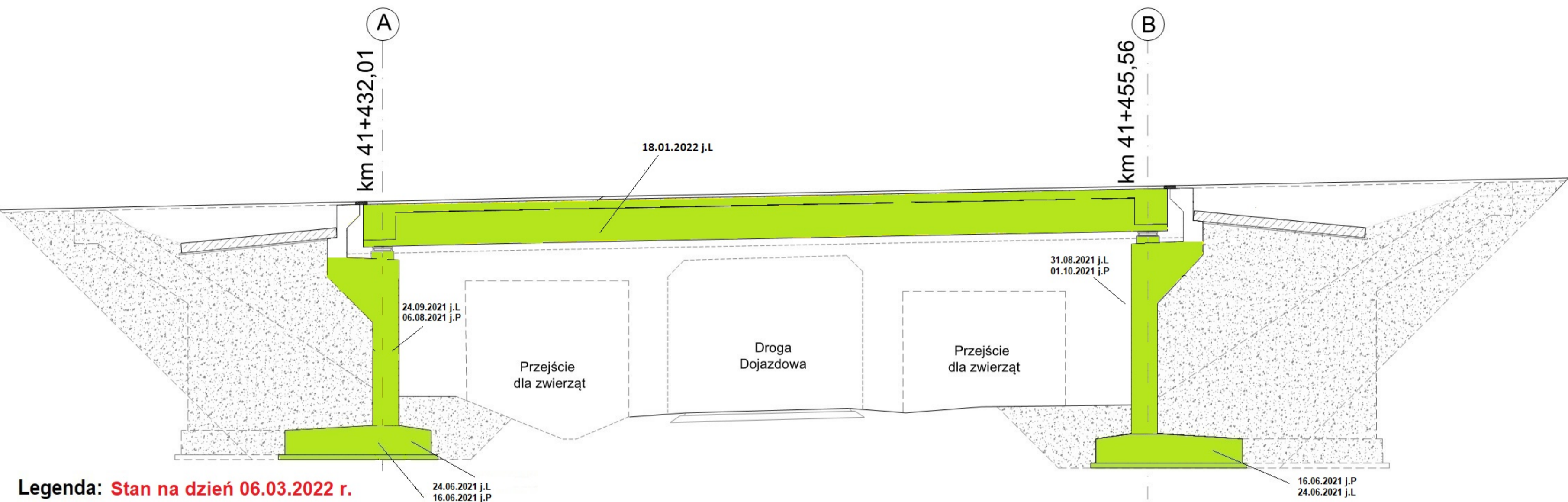

Legenda: **Stan na dzień 06.03.2022 r.**

- Roboty w trakcie wykonywania
- Roboty zakończone



# MS-25

km 41+996,65

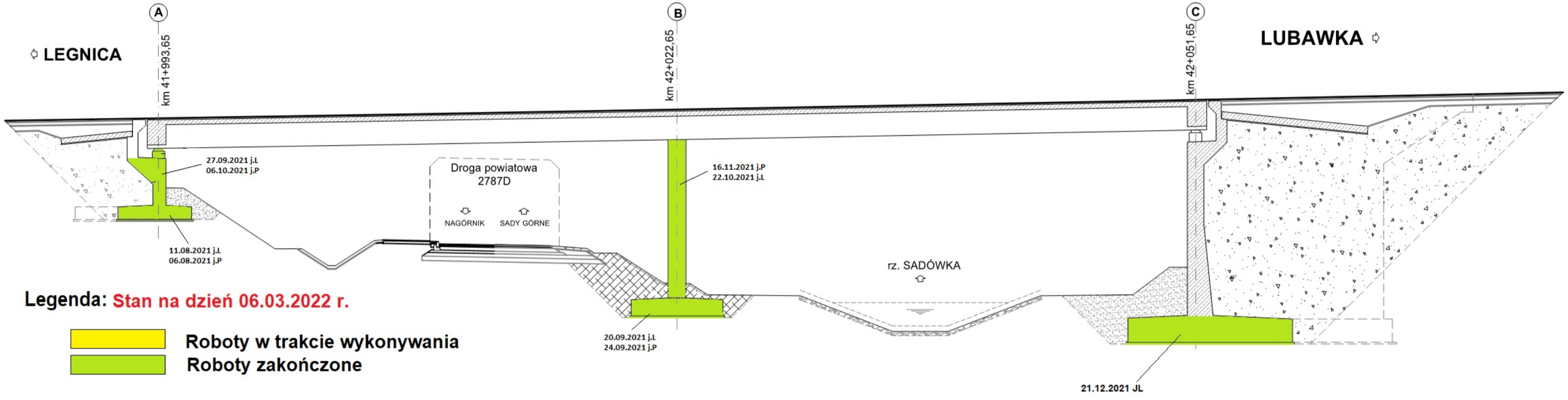

Legenda: Stan na dzień 06.03.2022 r.

- Roboty w trakcie wykonywania
- Roboty zakończone

PRZEKRÓJ POPRZECZNY  
PRZESŁOYT NORMALNY

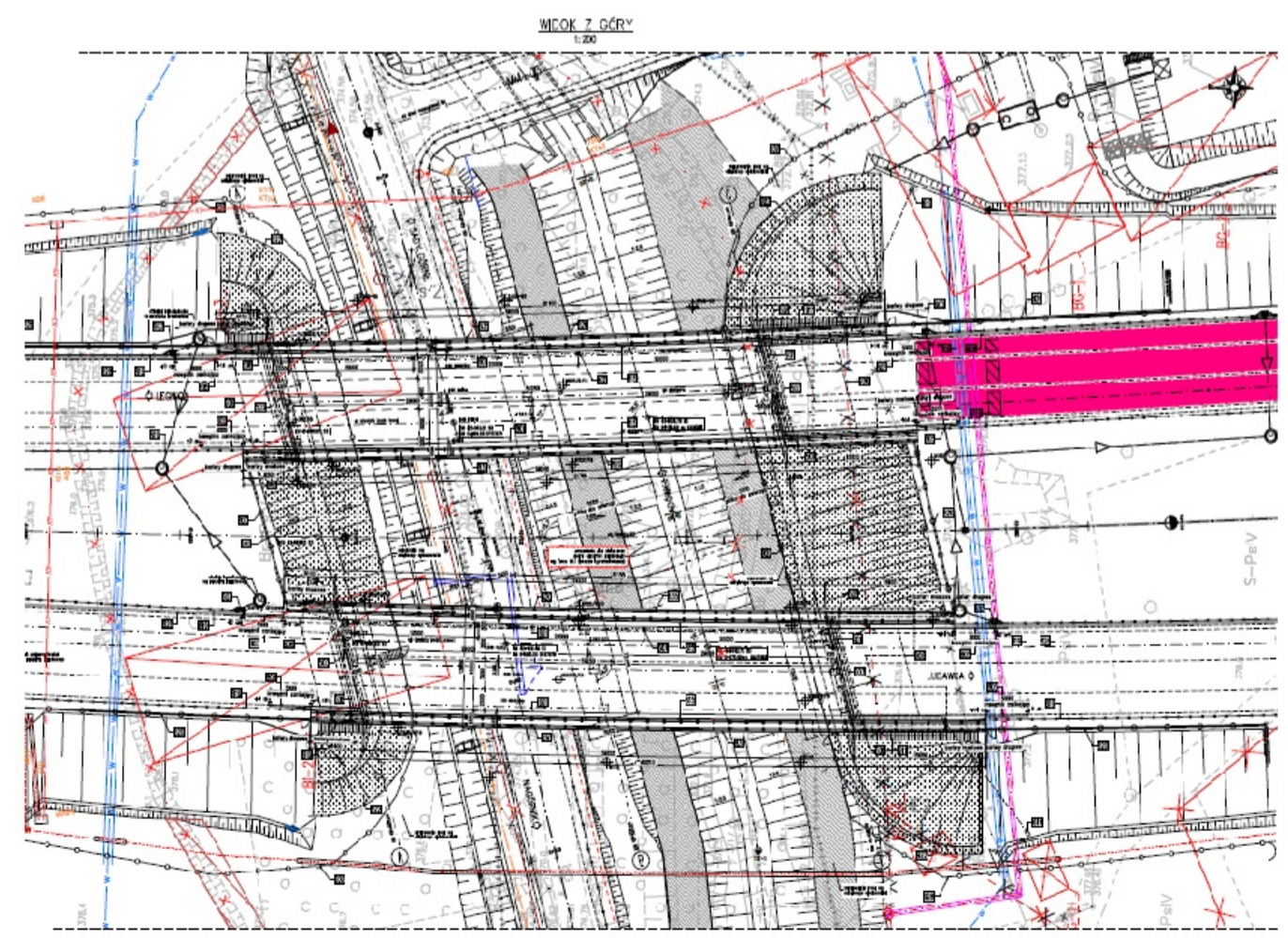
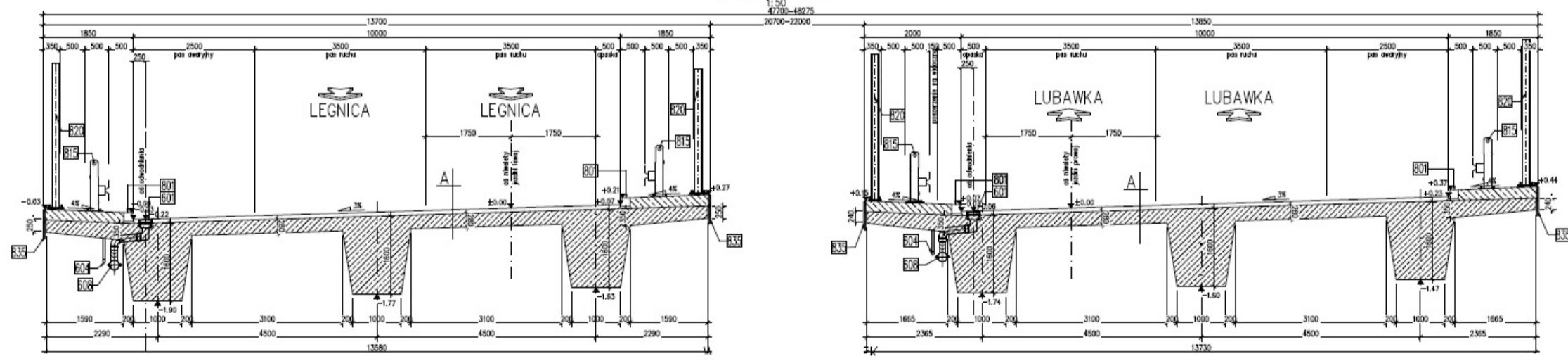

# PG-29

km 46+743,46

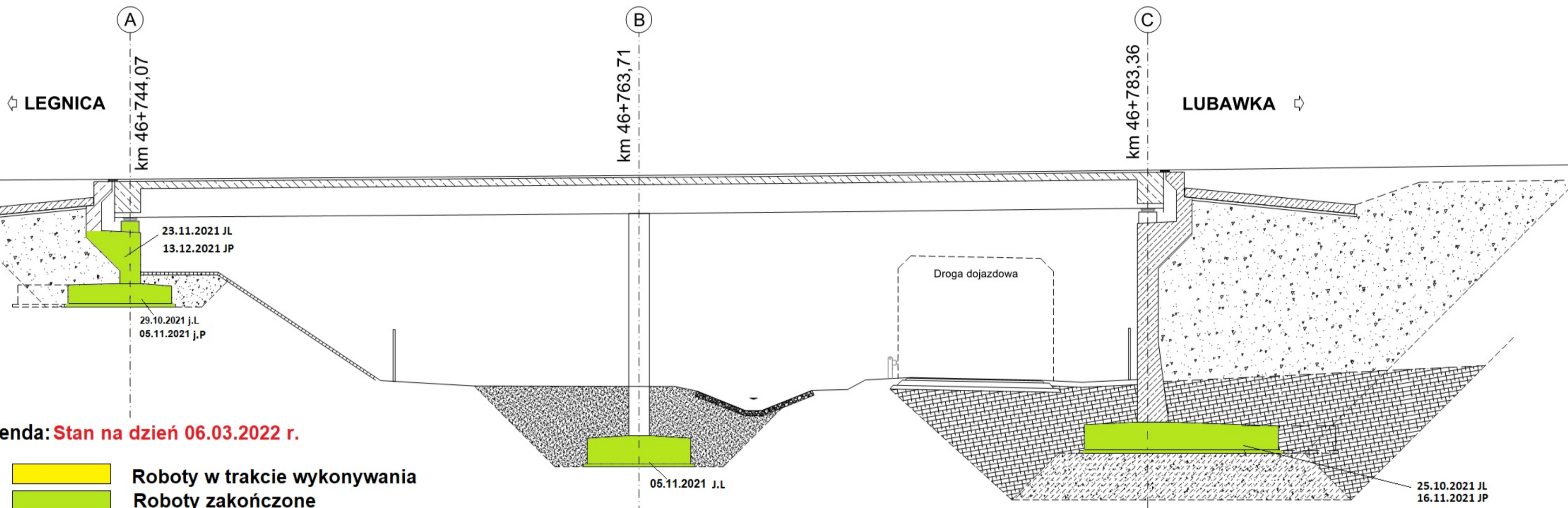

Legenda: Stan na dzień 06.03.2022 r.

- Roboty w trakcie wykonywania
- Roboty zakończone

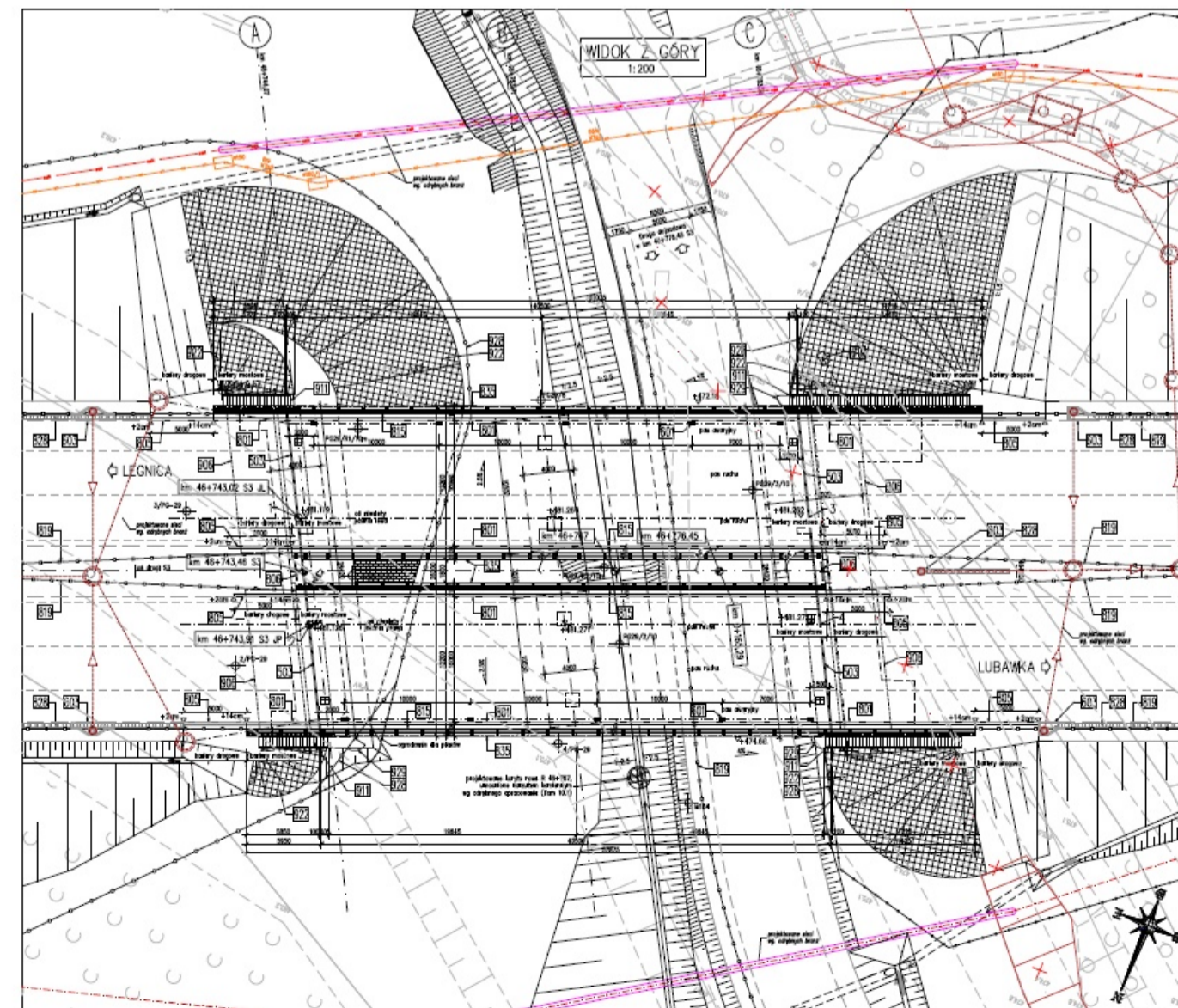
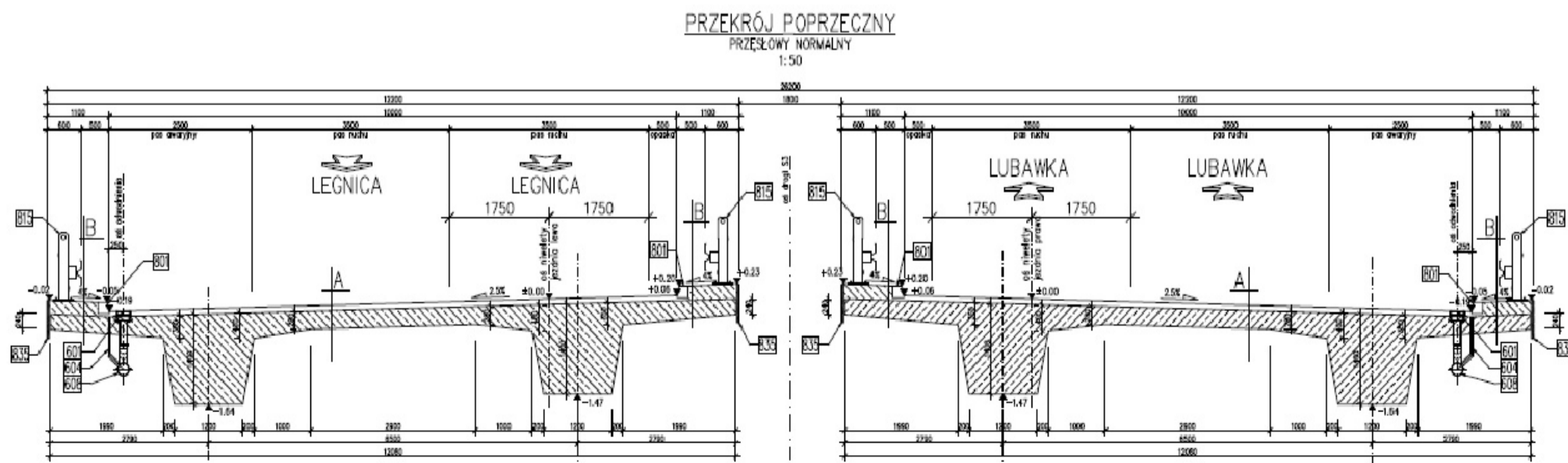

# WS-31 km 47+568,12

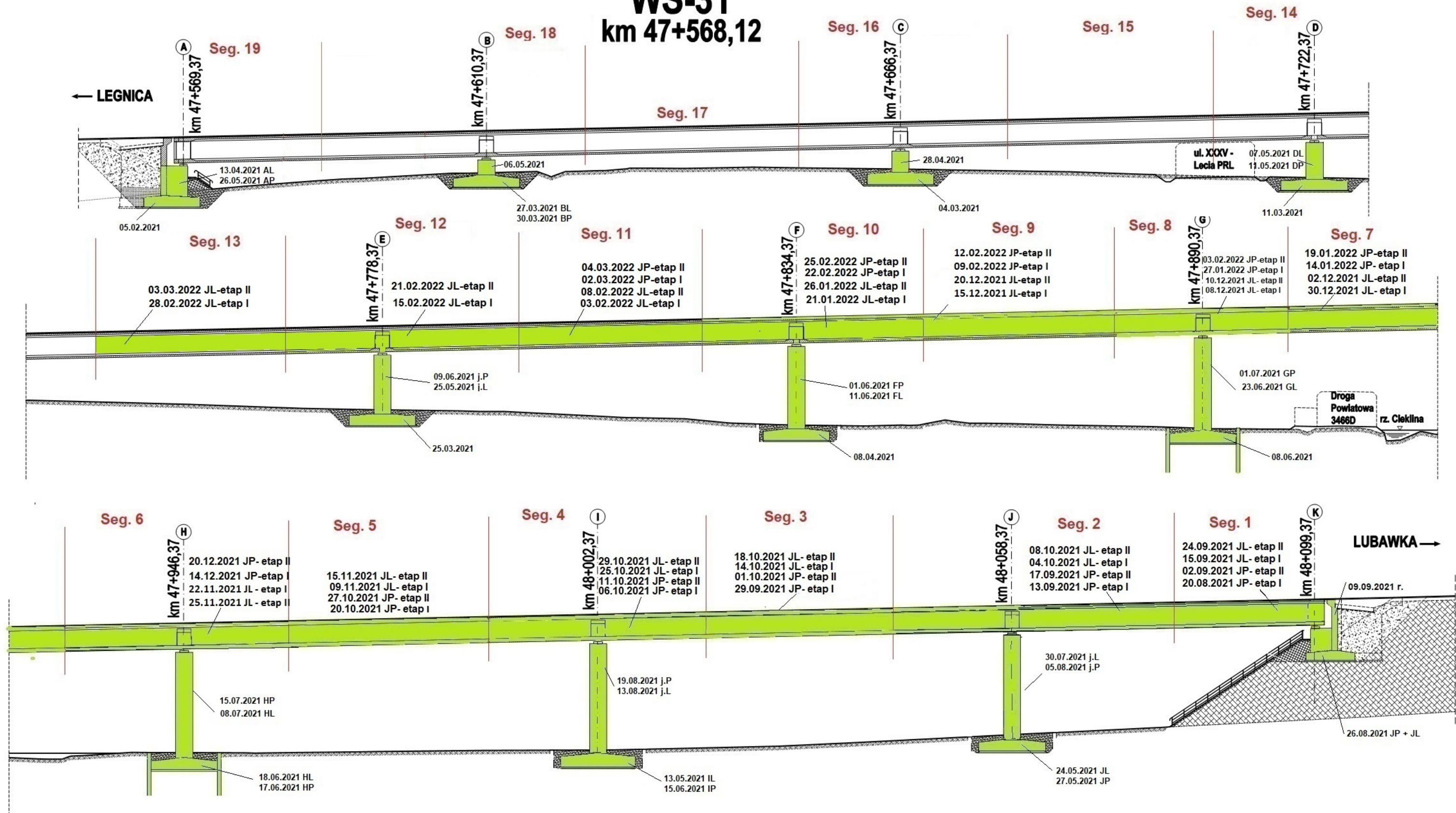

**Legenda: Stan na dzień 06.03.2022 r.**

- Roboty w trakcie
- Roboty zakończone

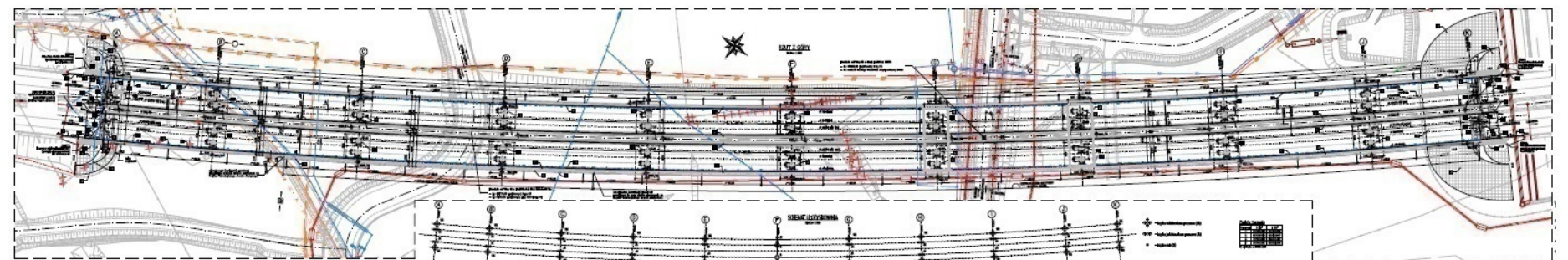
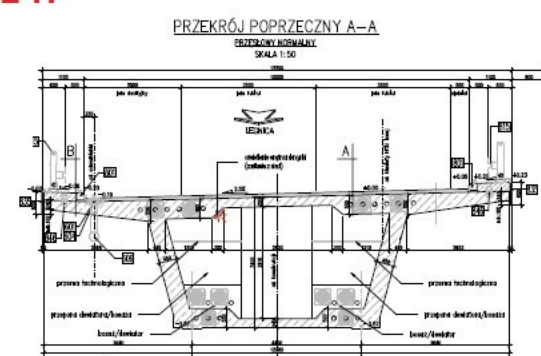

# TUNEL TS-32

## km 48+680,00 - 49+000,00

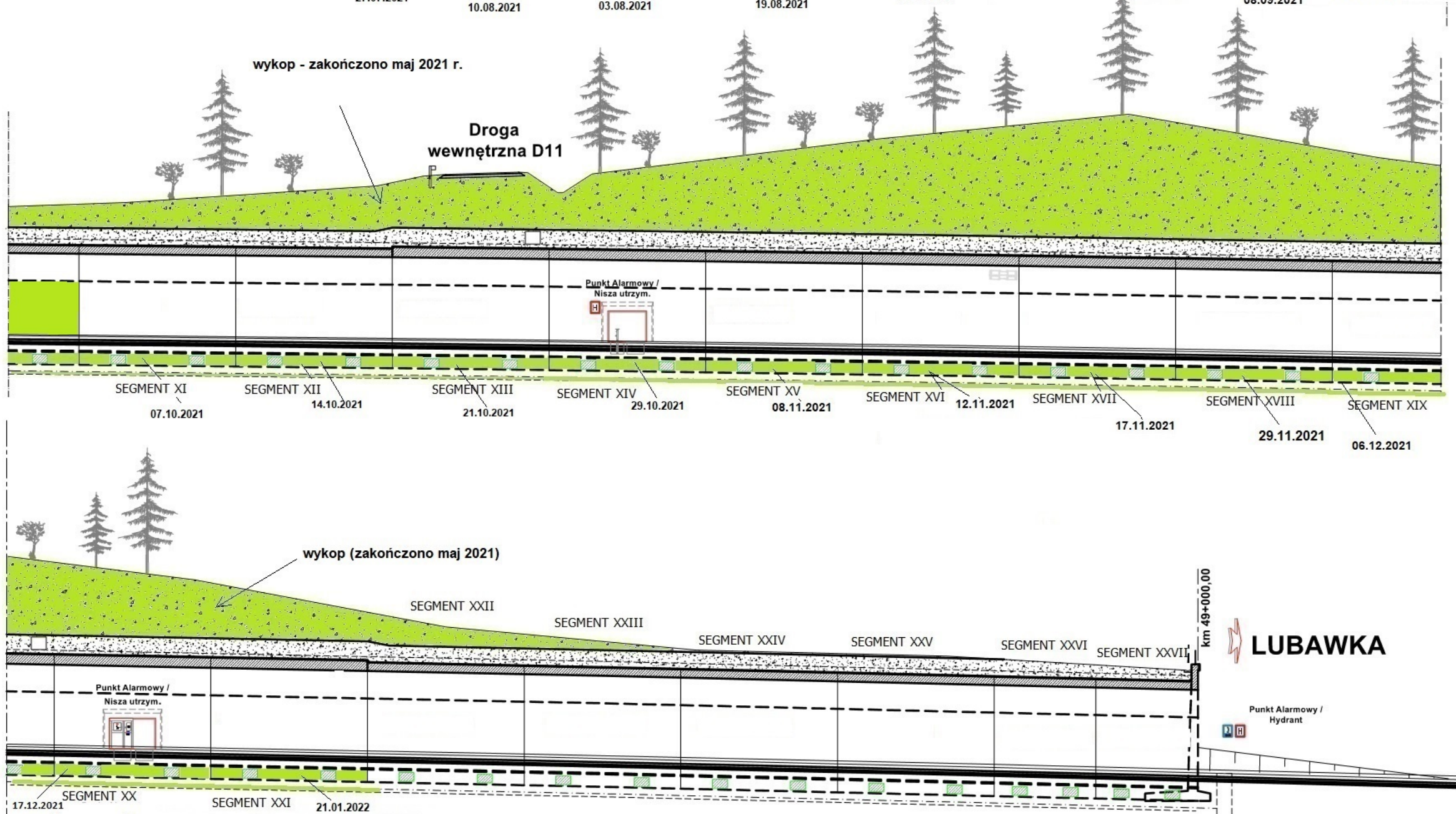
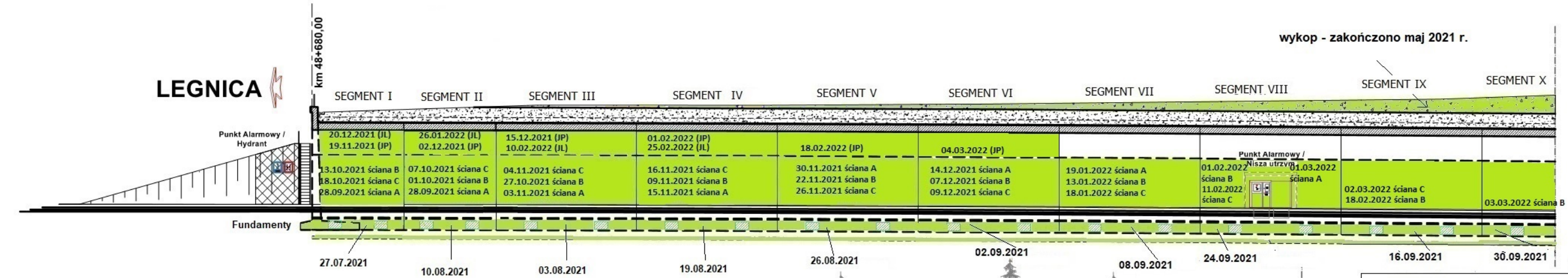

**Legenda: Stan na dzień 06.03.2022 r.**

- Roboty w trakcie wykonywania
- Roboty zakończone

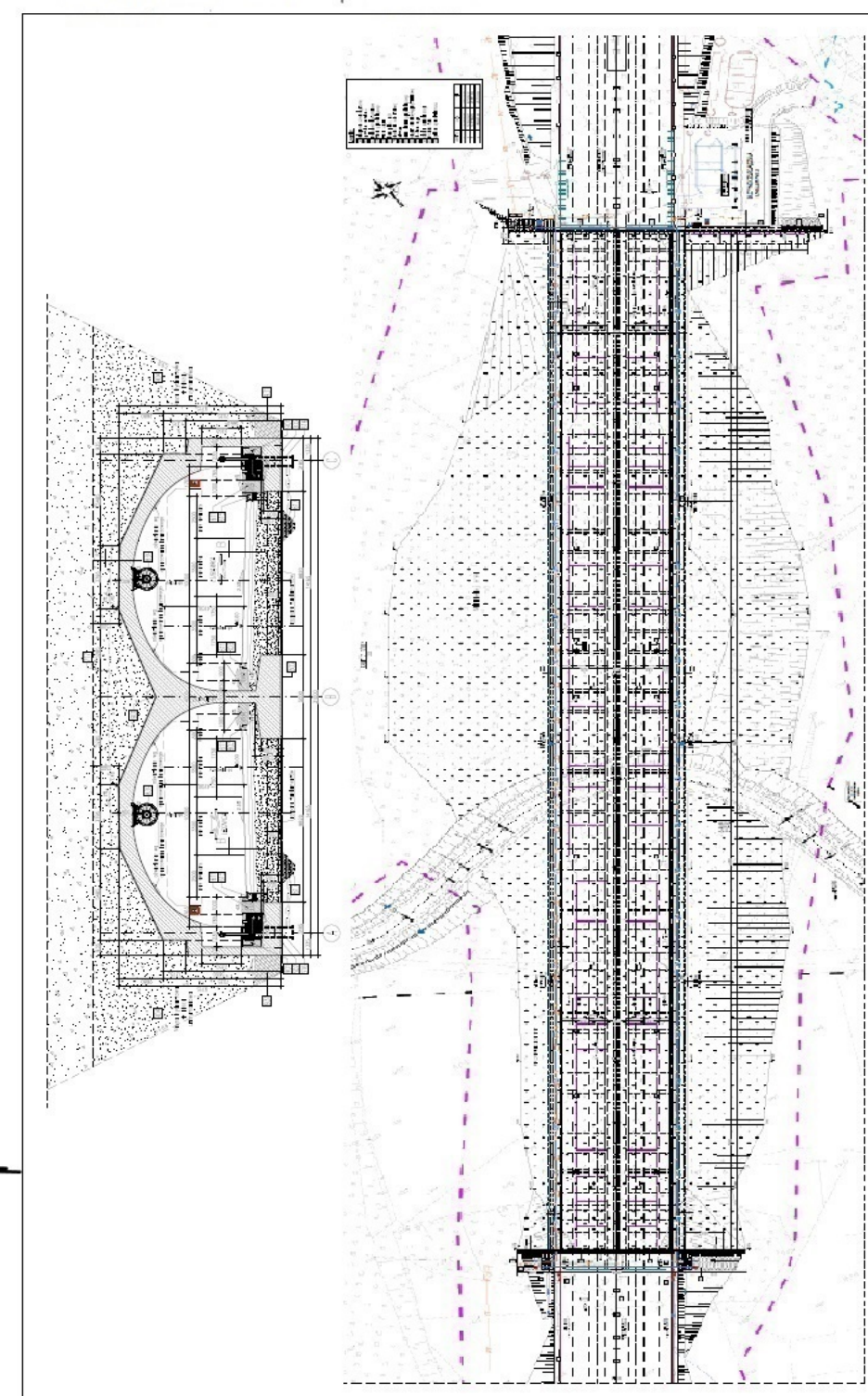

# PG 10.1

## km 50+097,00

← LEGNICA

LUBAWKA →

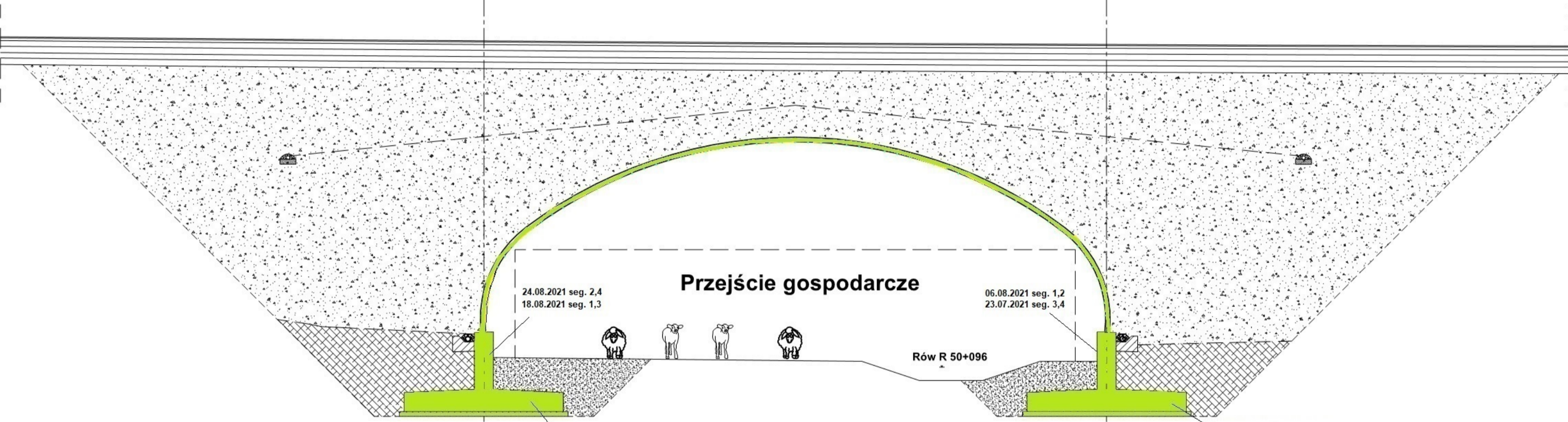

Legenda: Stan na dzień 06.03.2022 r.

- Roboty w trakcie wykonywania
- Roboty zakończone

05.07.2021 seg. 1,3  
24.06.2021 seg. 2,4

06.08.2021 seg. 1,2  
23.07.2021 seg. 3,4

08.07.2021 seg. 1,3  
29.07.2021 seg. 2,4

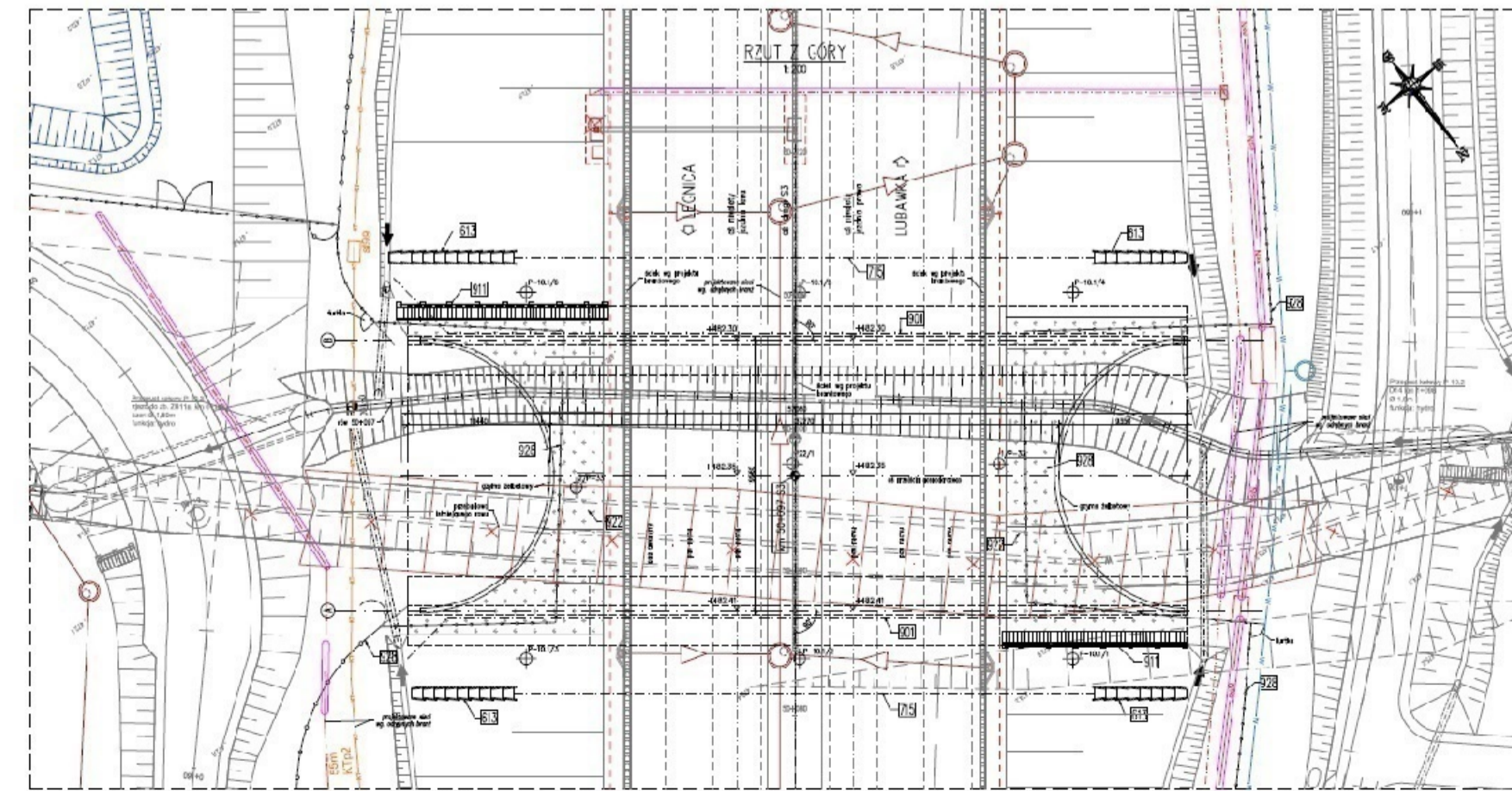
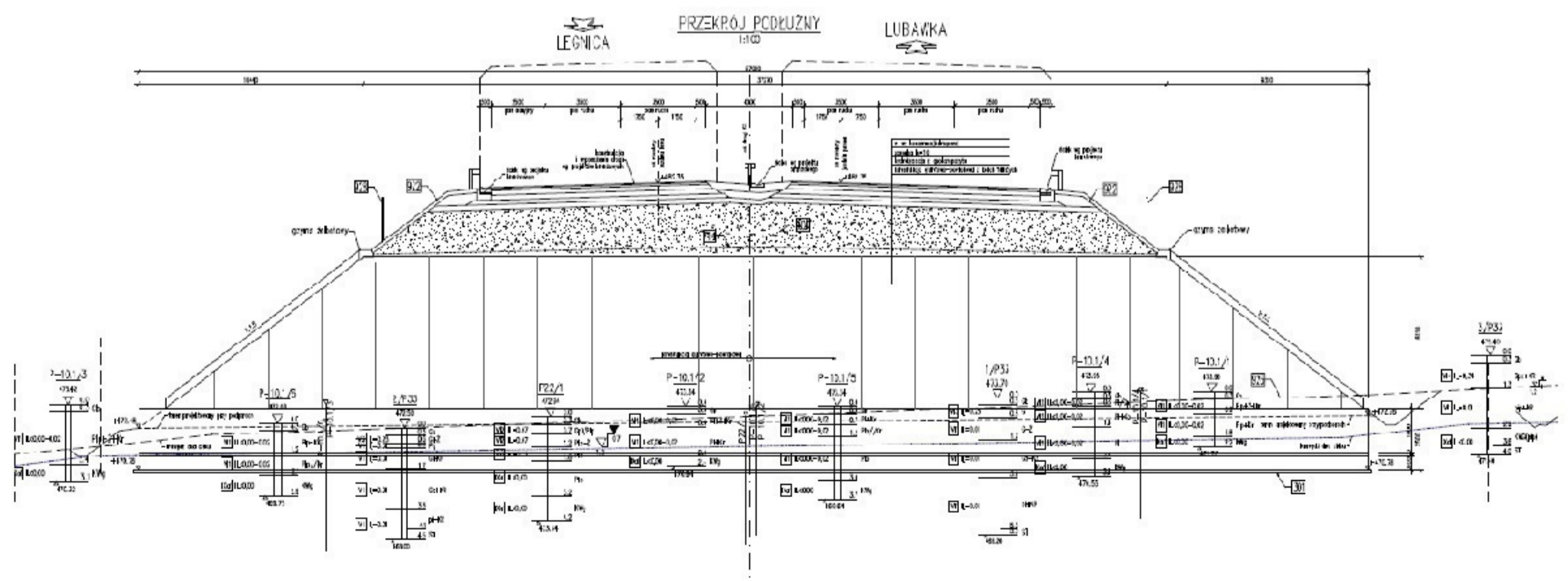

**WS-33**  
km 49+530,70

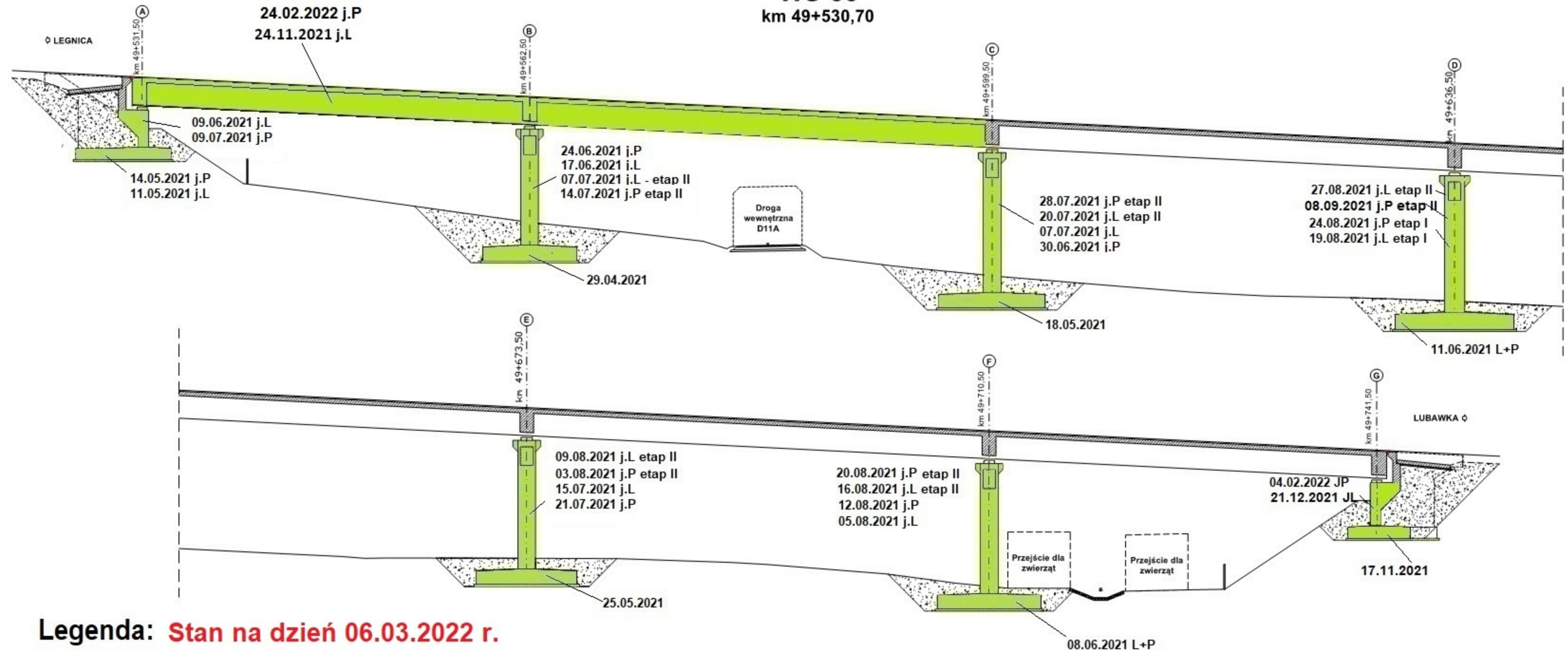

**Legenda: Stan na dzień 06.03.2022 r.**

- Roboty w trakcie wykonywania
- Roboty zakończone

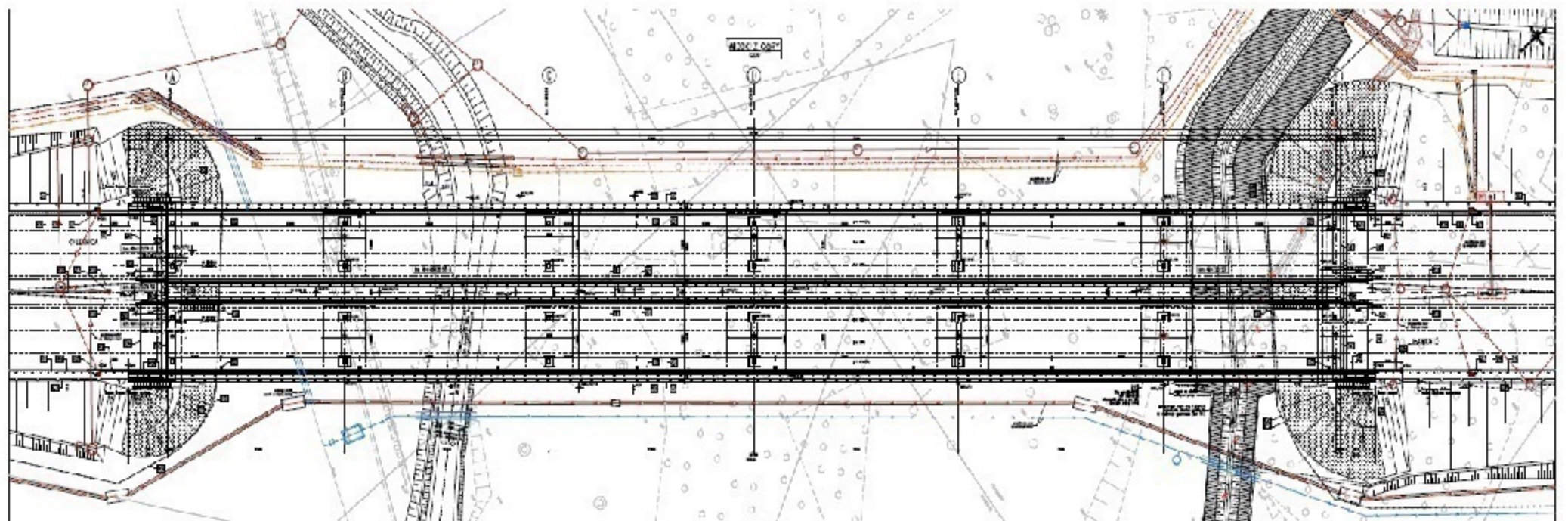
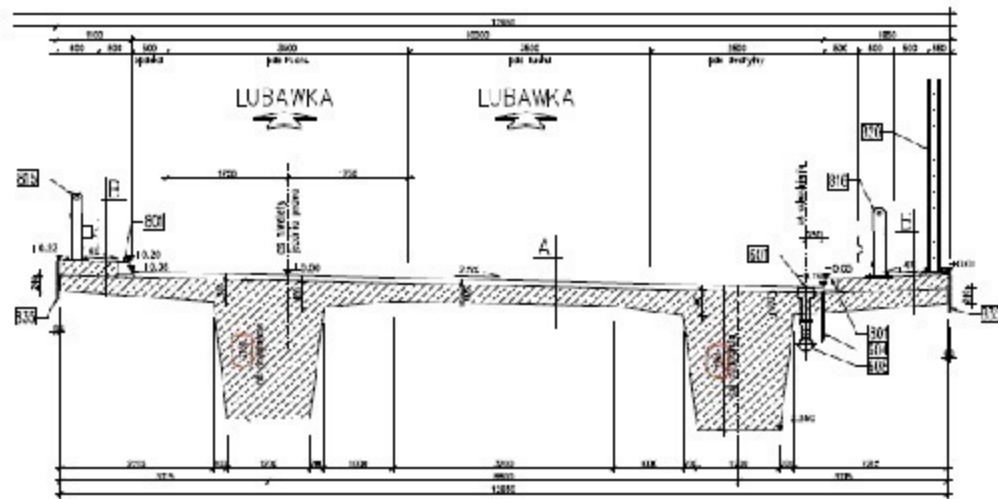



# WD-34

## km 50+661,15

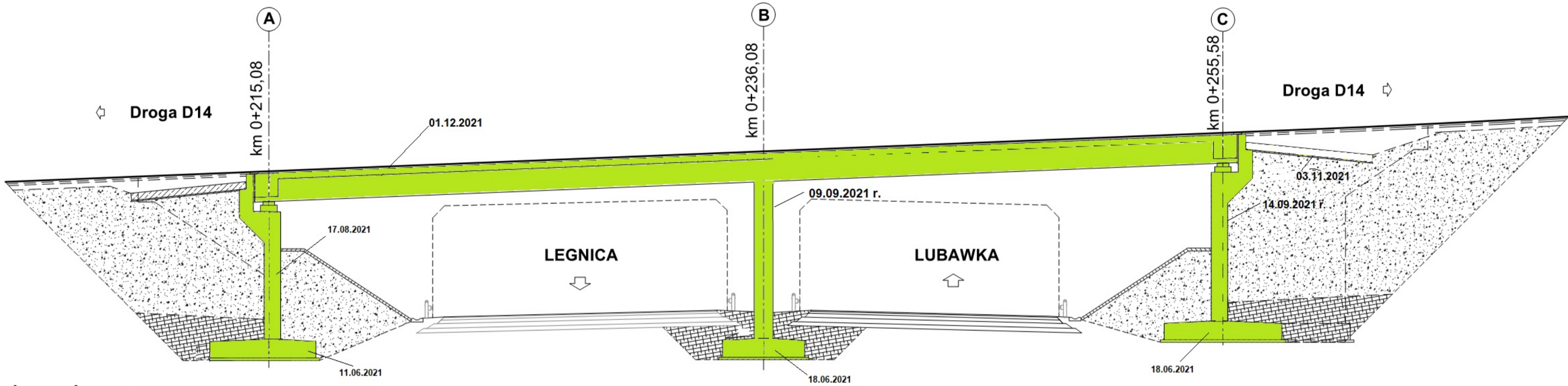

Legenda: Stan na dzień 06.03.2022 r.

- Roboty w trakcie wykonywania
- Roboty zakończone

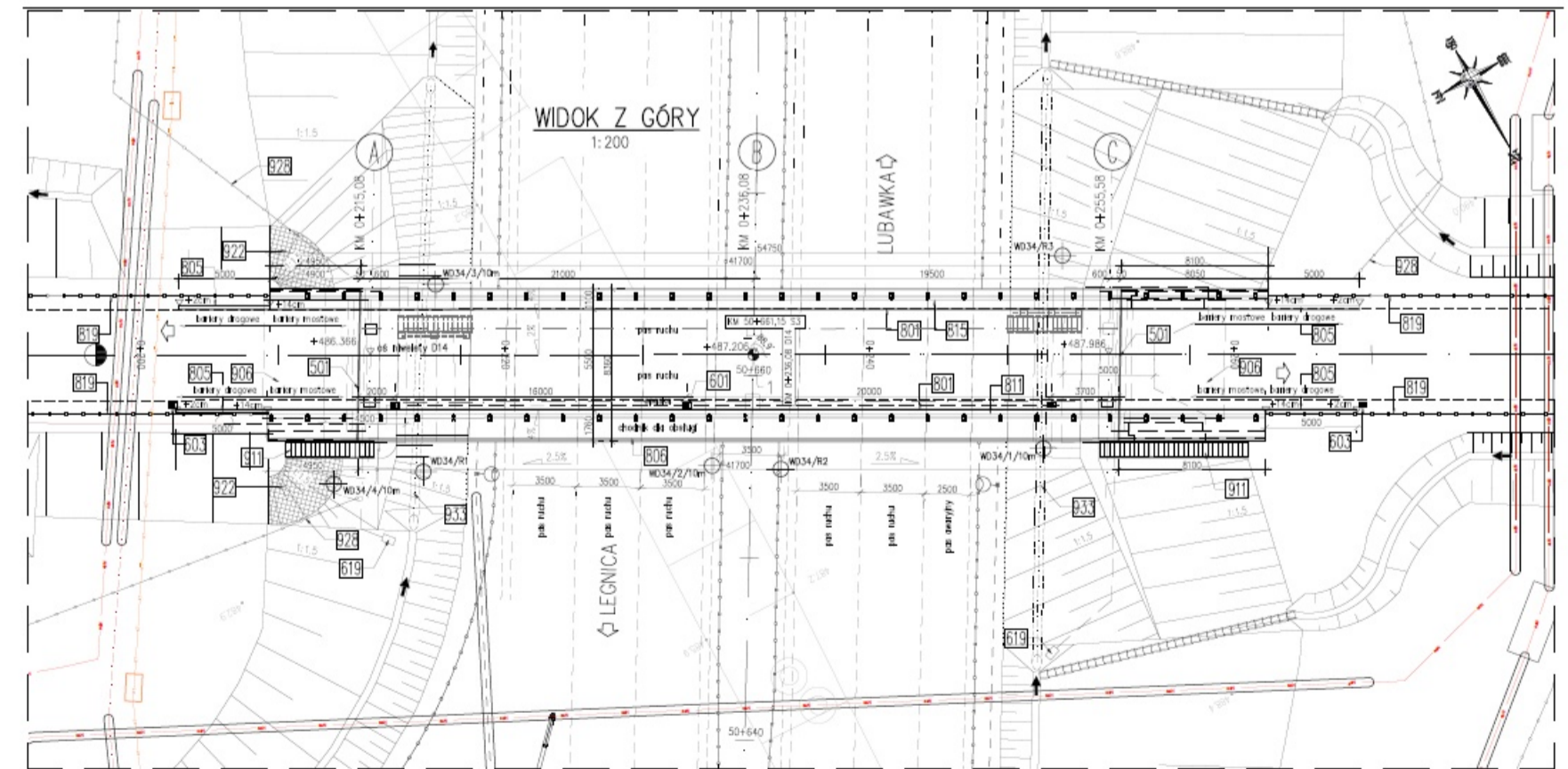
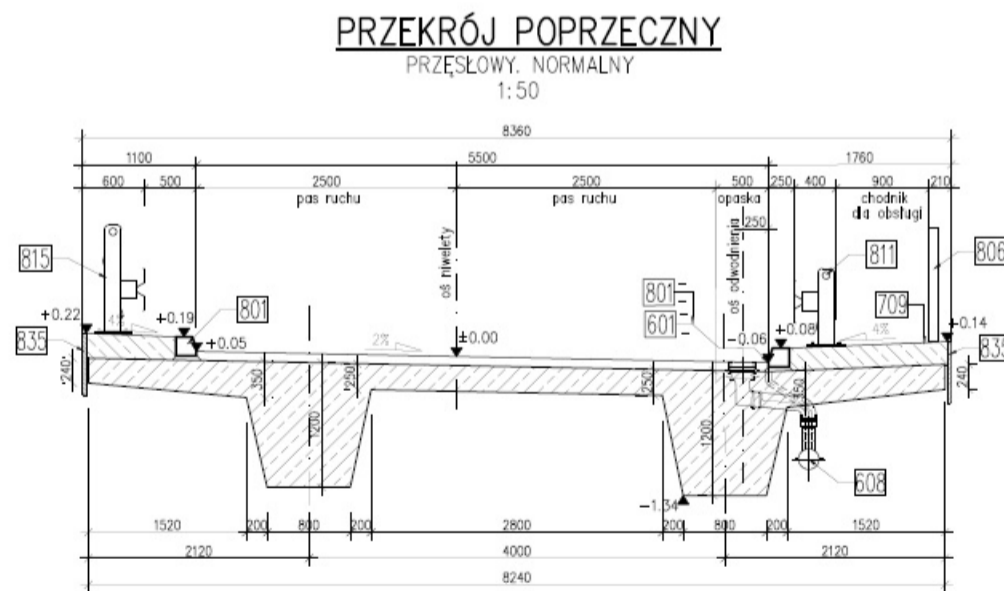

# PG 11.1

## km 51+249,00

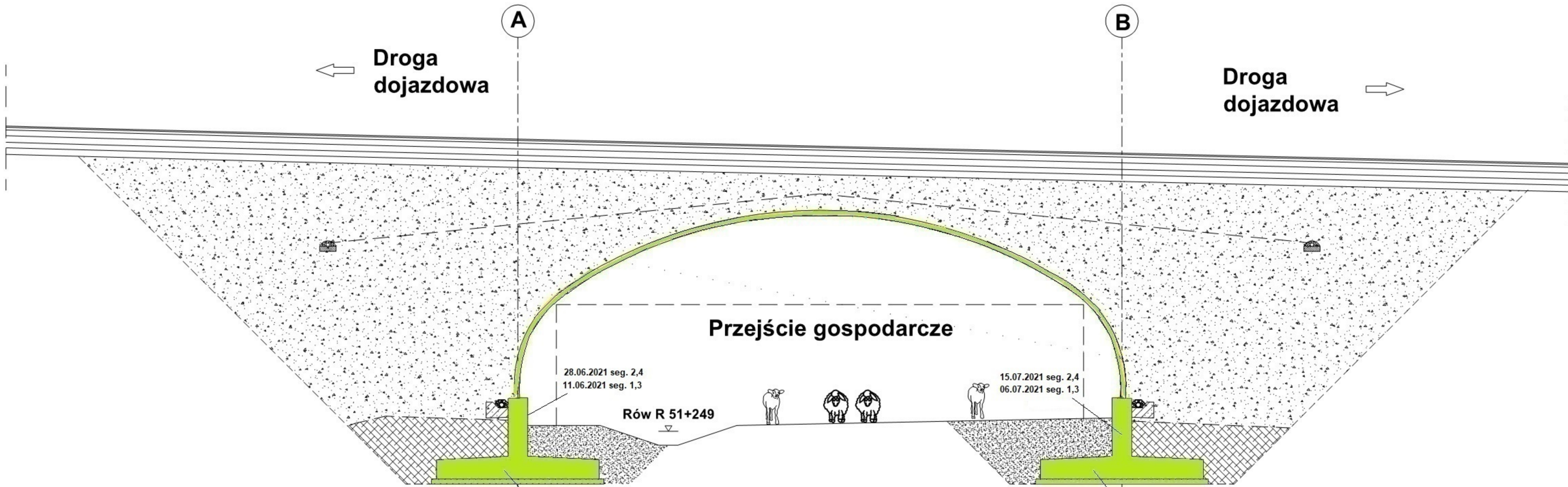

Legenda: Stan na dzień 06.03.2022 r.

- Roboty w trakcie wykonywania
- Roboty zakończone

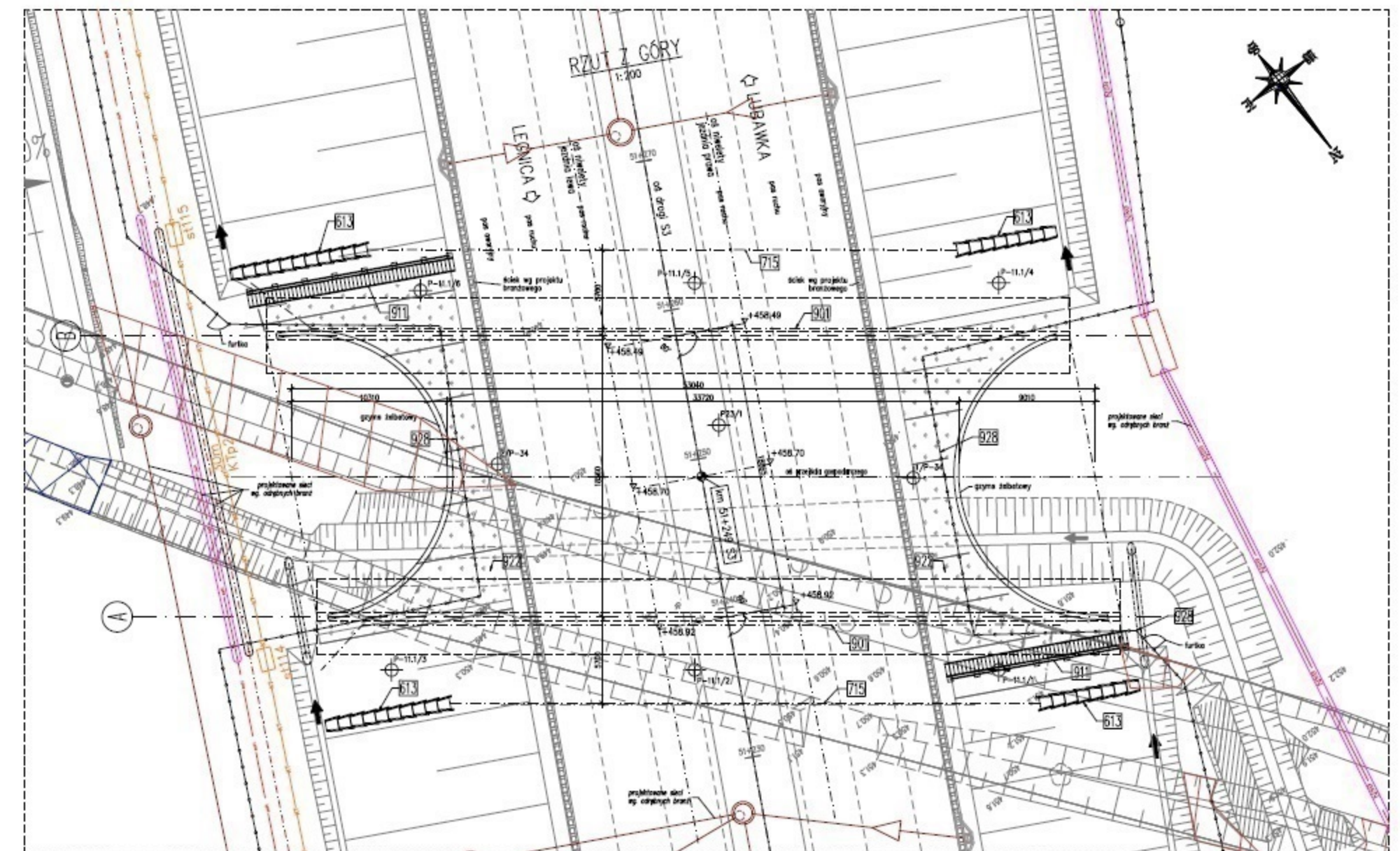
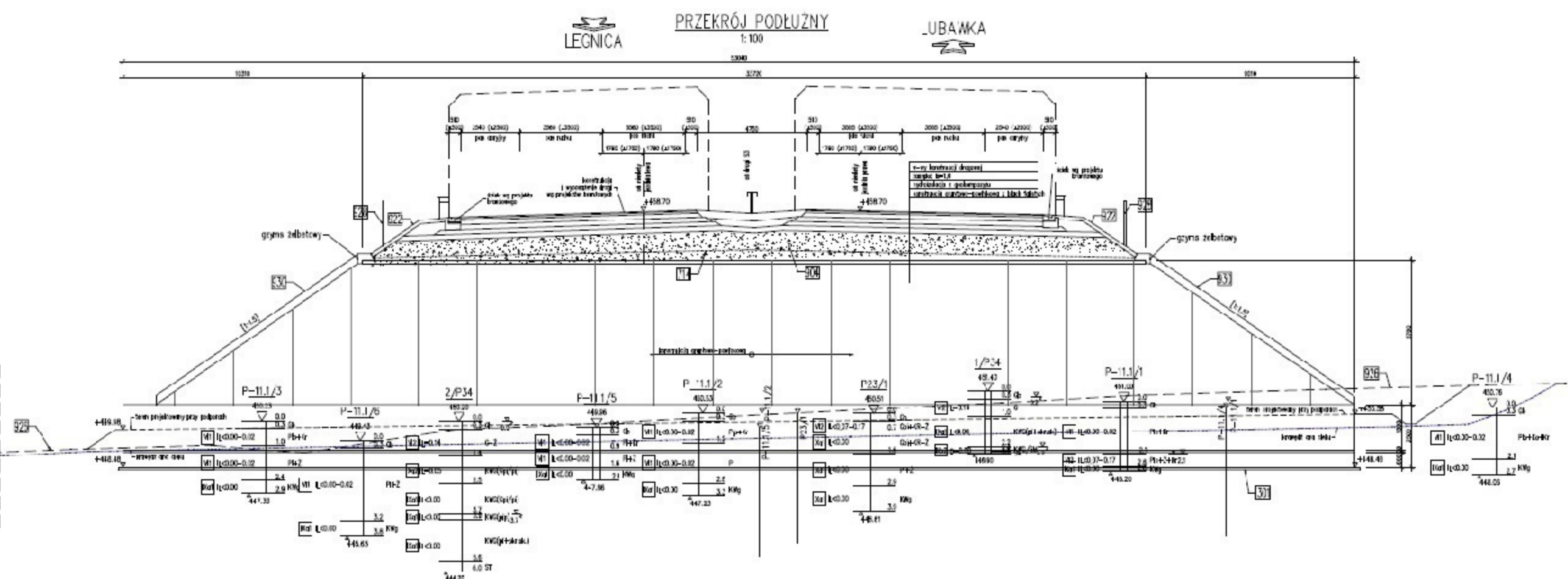

# WS-35

## km 51+508,81

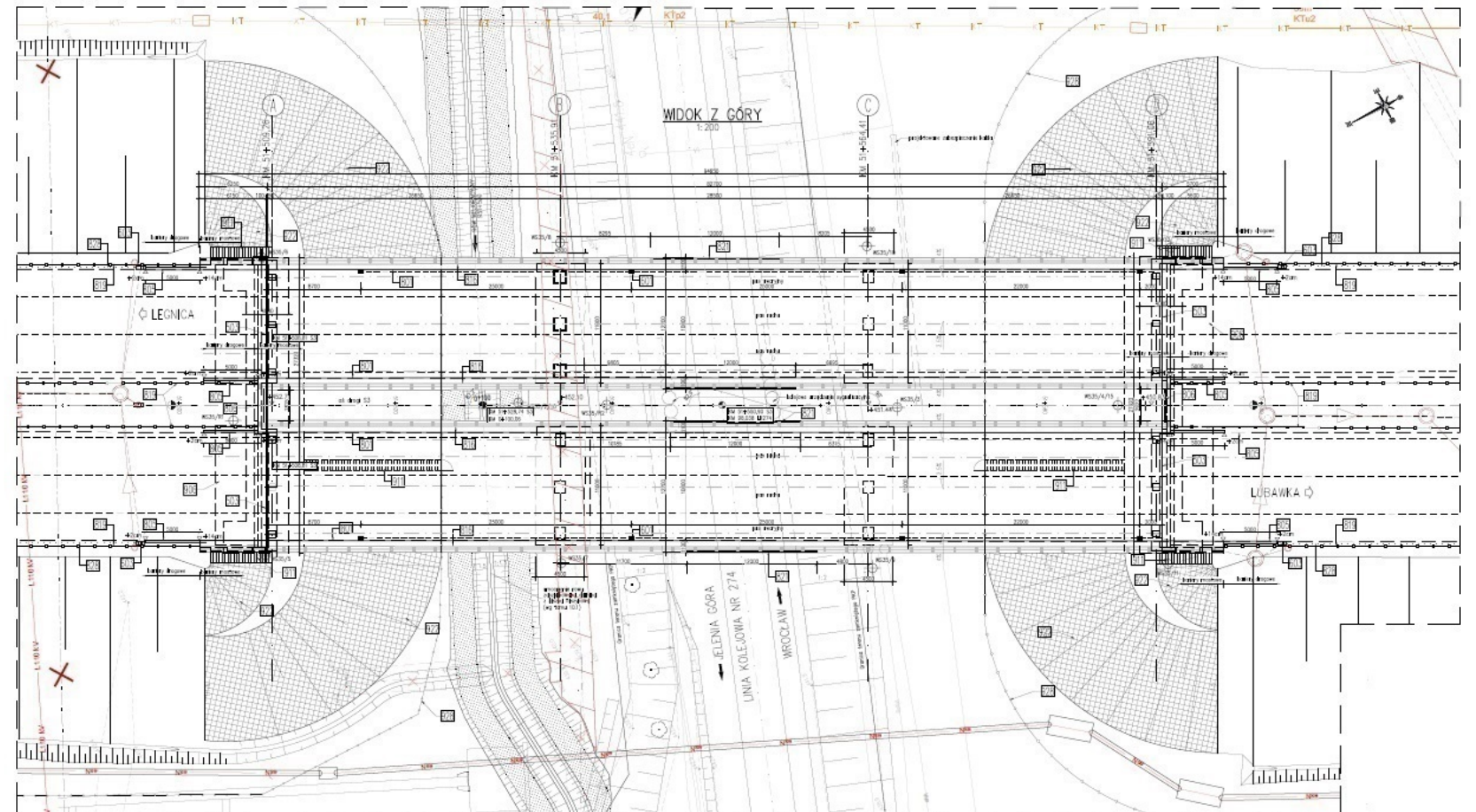
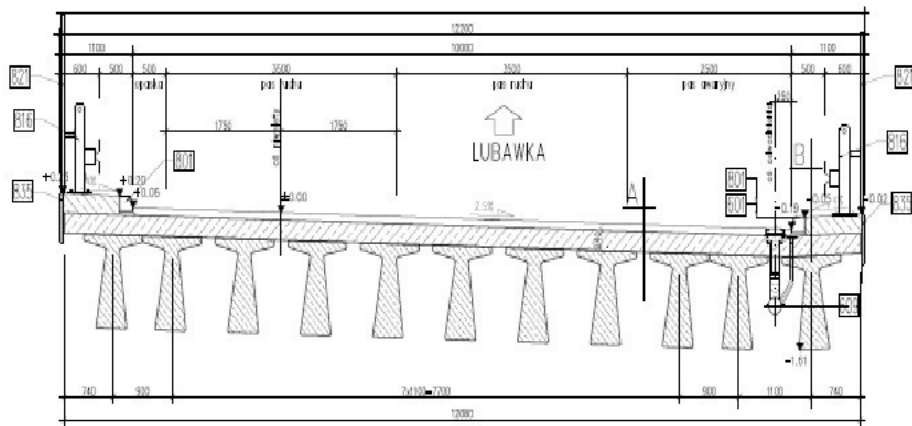
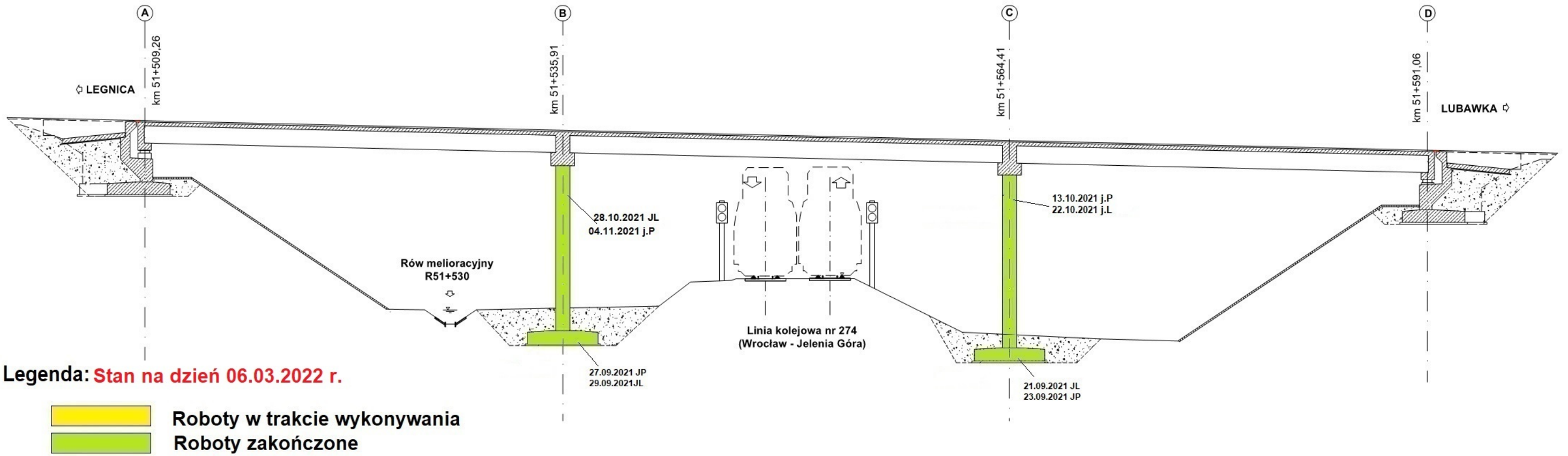

# WS-36

## km 51+780,95

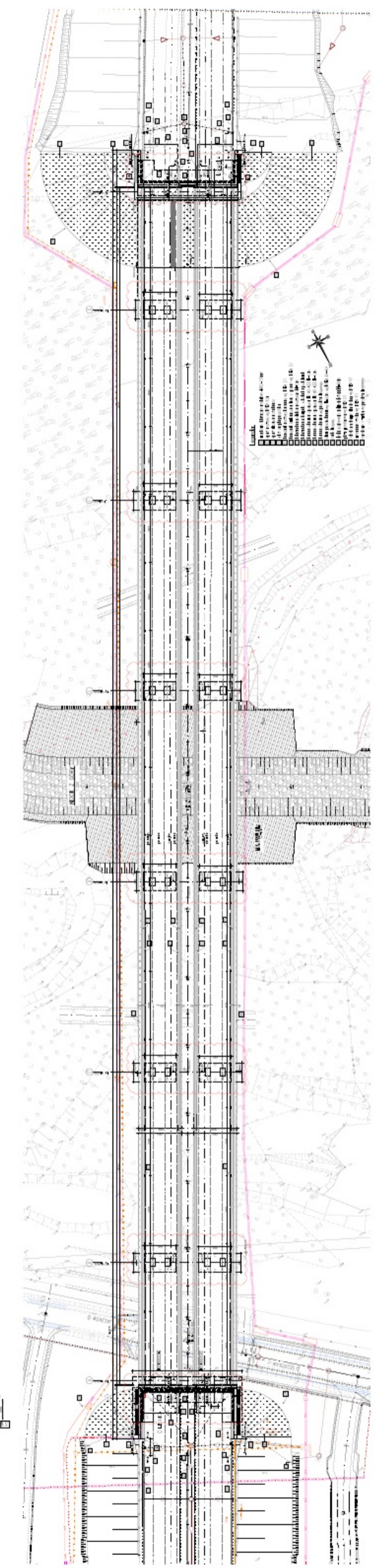
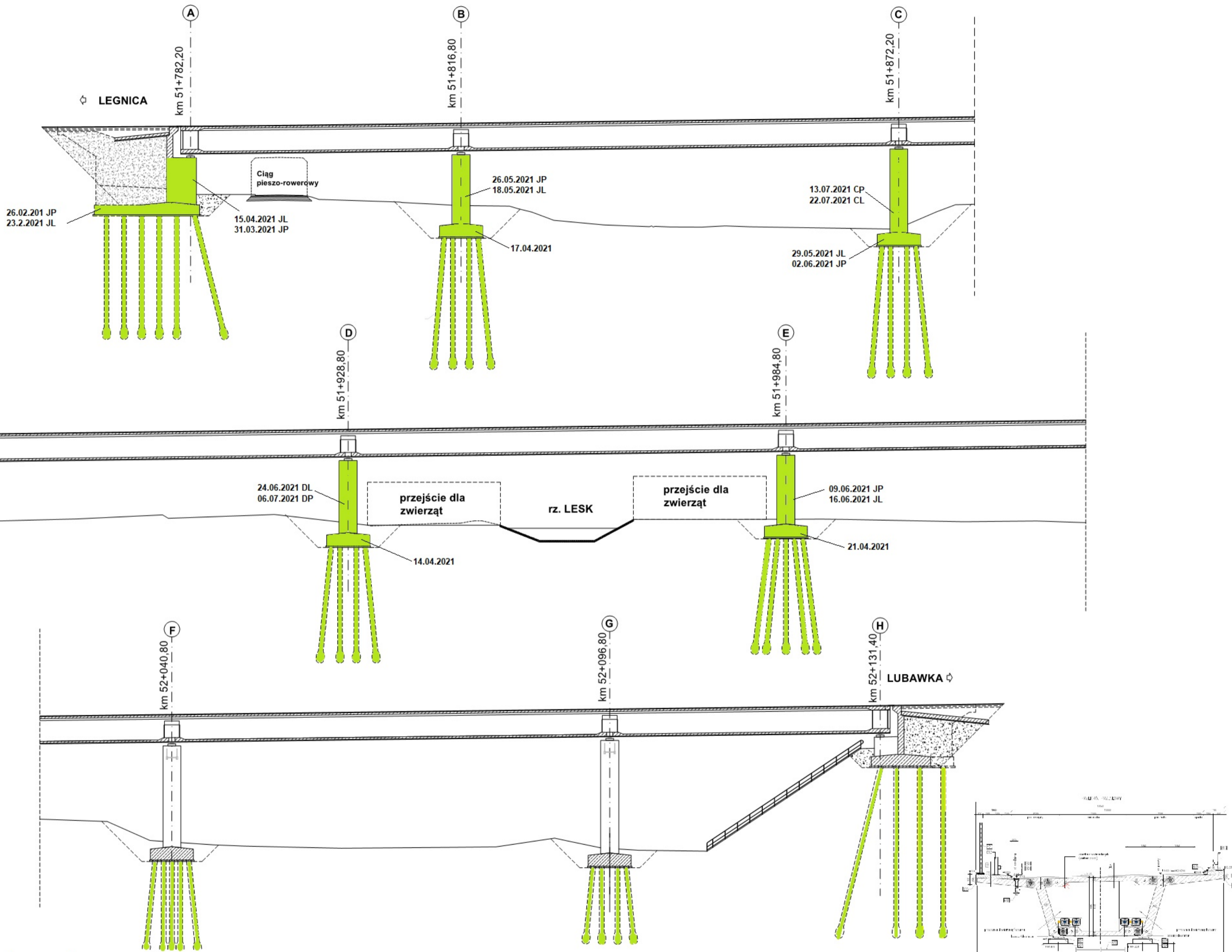

Legenda: Stan na dzień 06.03.2022 r.

- Roboty w trakcie wykonywania
- Roboty zakończone

# WS-37

km 52+994,25

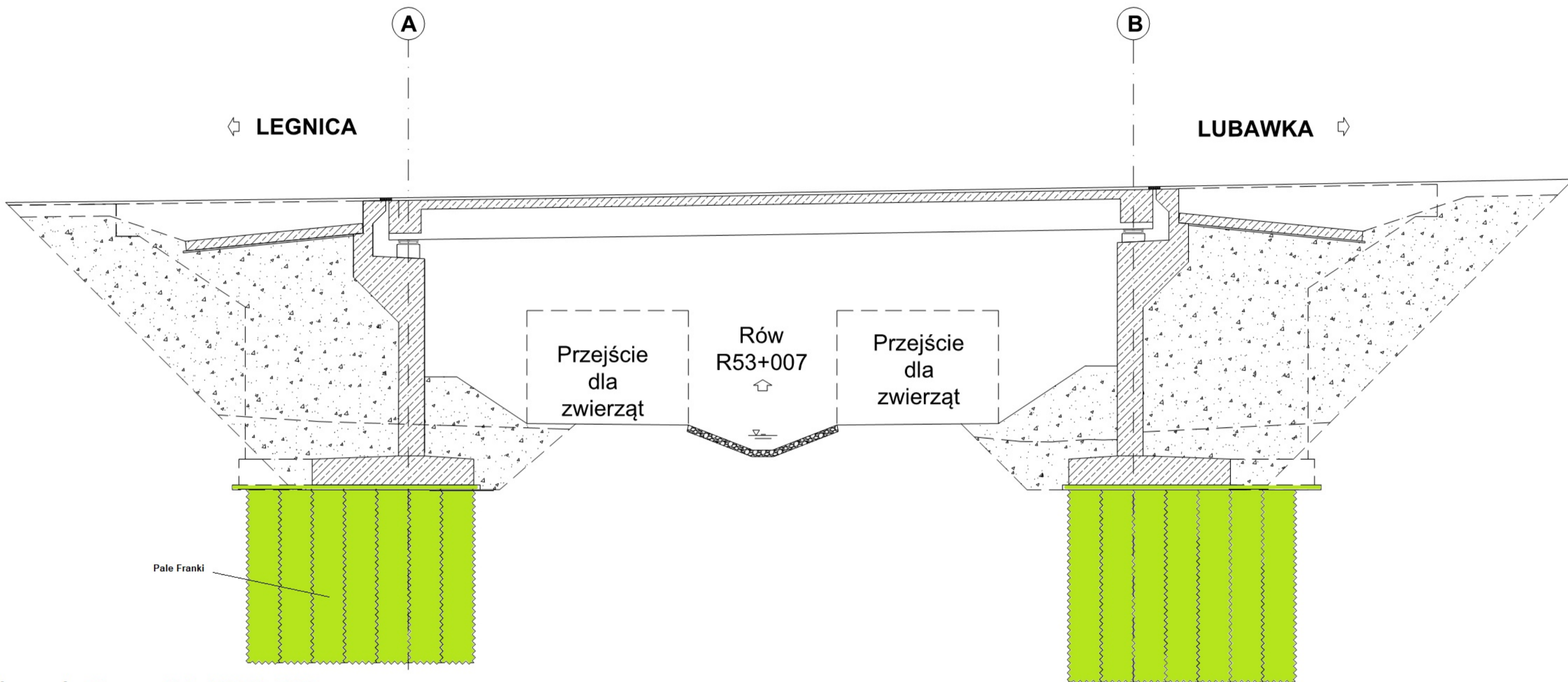

Legenda: Stan na dzień 06.03.2022 r.

- Roboty w trakcie wykonywania
- Roboty zakończone

PRZEKRÓJ POPRZECZNY  
PRZESELOWY, NORMALNY  
1:50

