

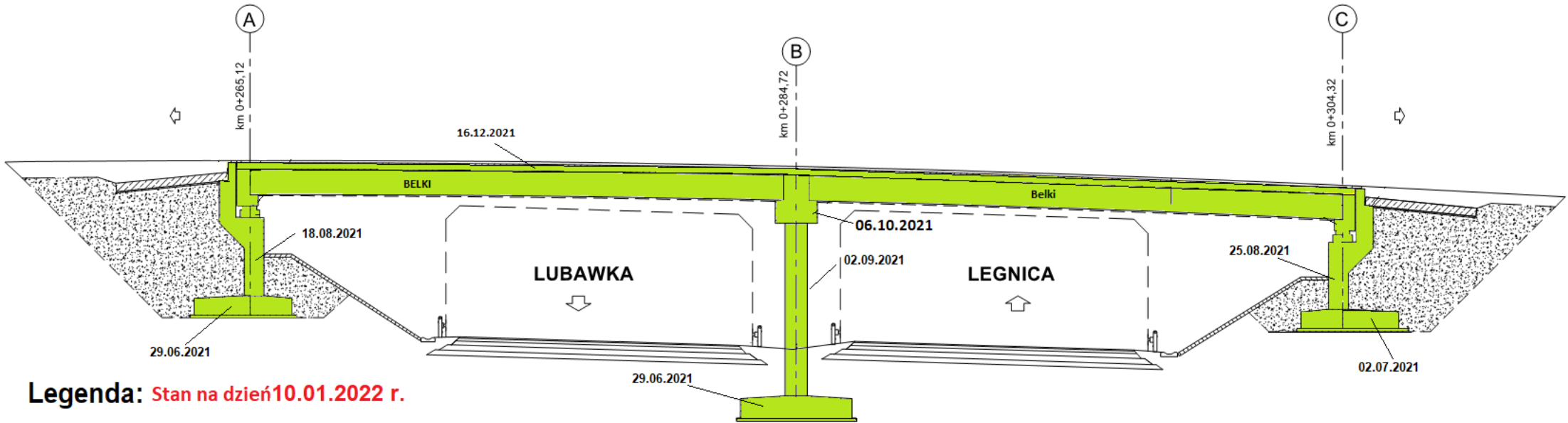

WD-22

km 38+491,21

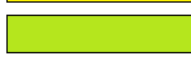

Legenda: Stan na dzień 10.01.2022 r.

-  Roboty w trakcie wykonywania
-  Roboty zakończone

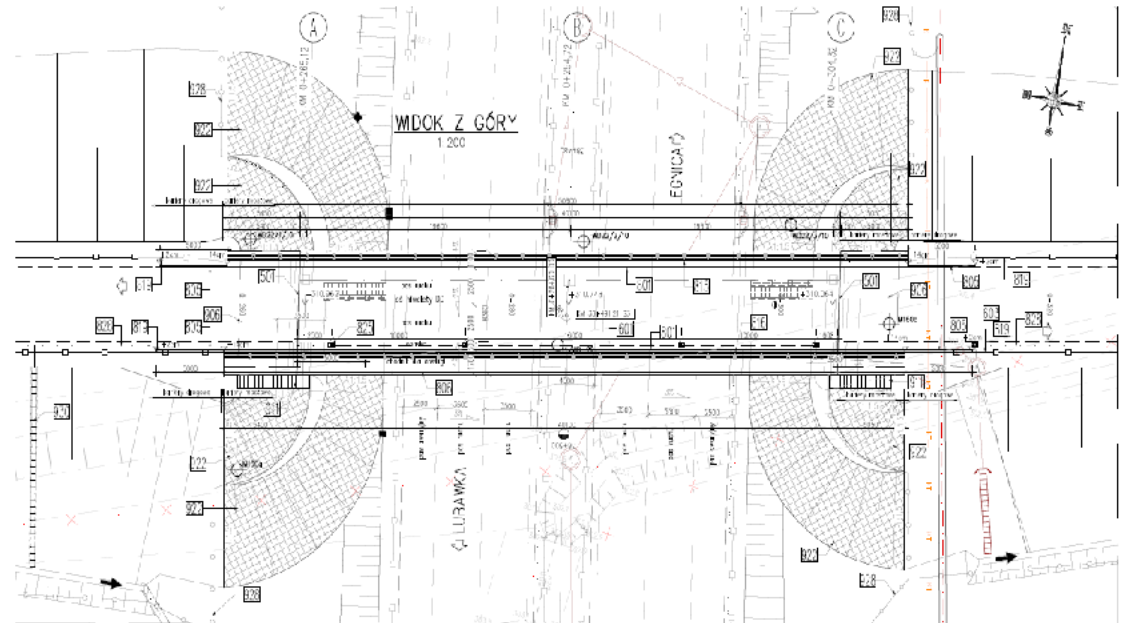
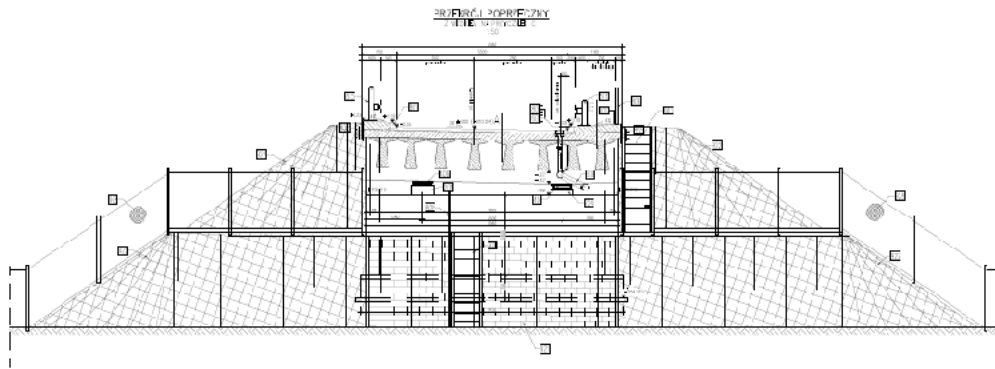

WS-24

km 41+431,41

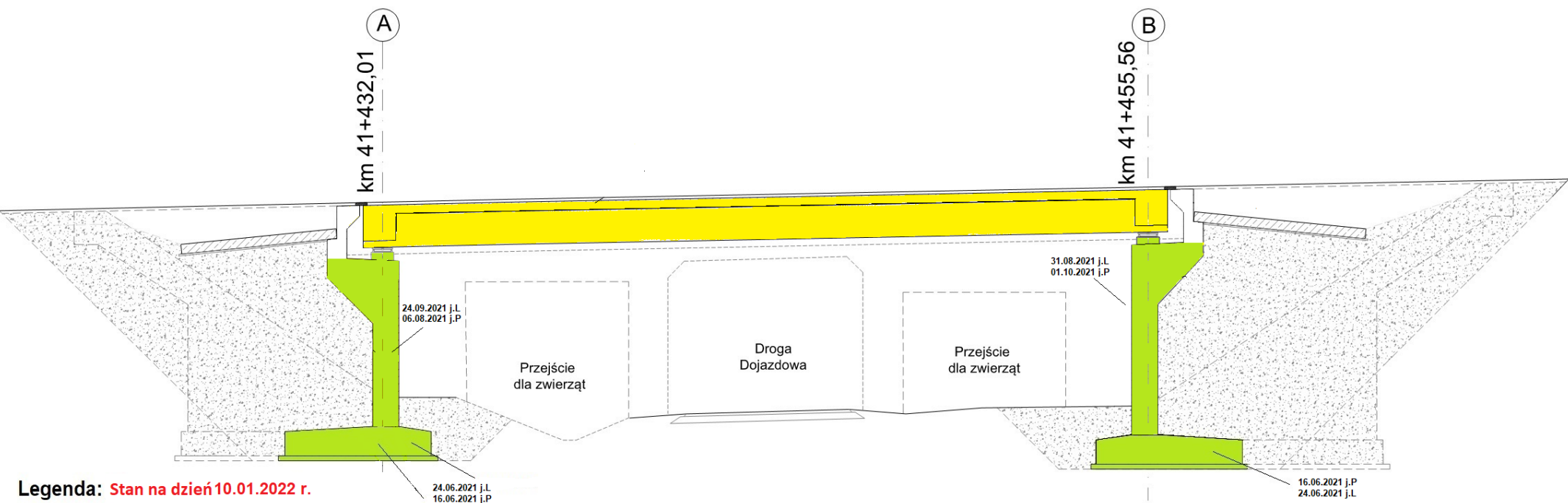

Legenda: Stan na dzień 10.01.2022 r.

- Roboty w trakcie wykonywania
- Roboty zakończone

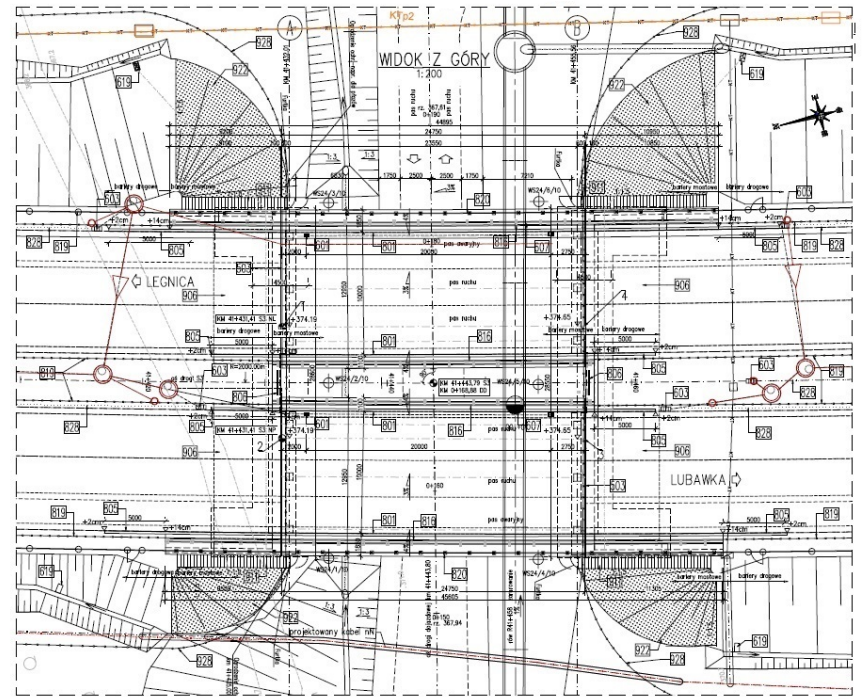
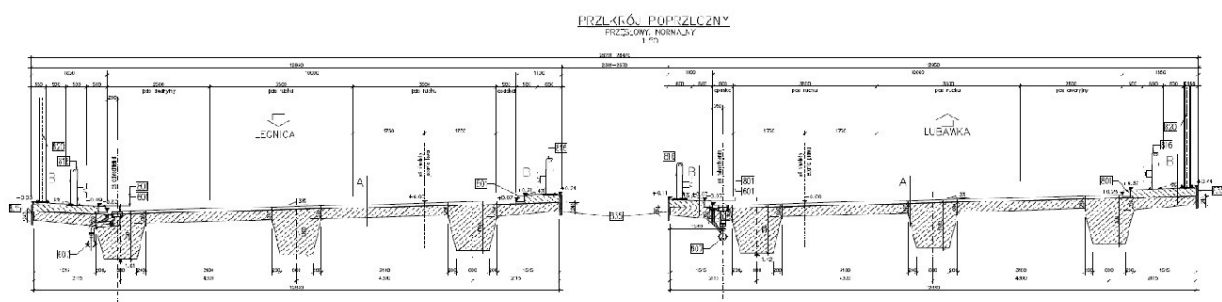

MS-25

km 41+996,65

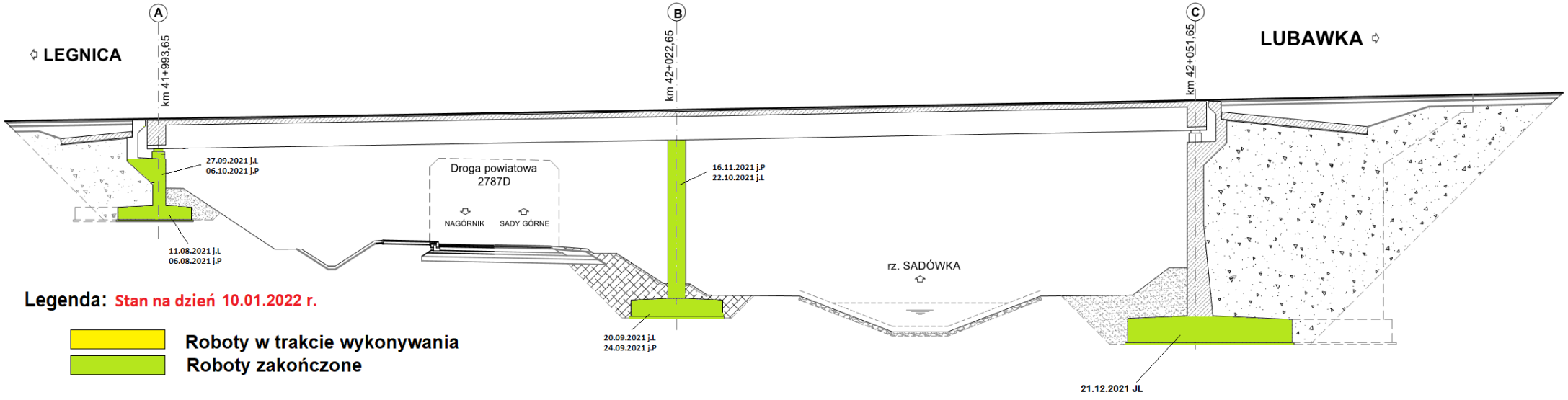

PRZEKRÓJ POPRZECZNY

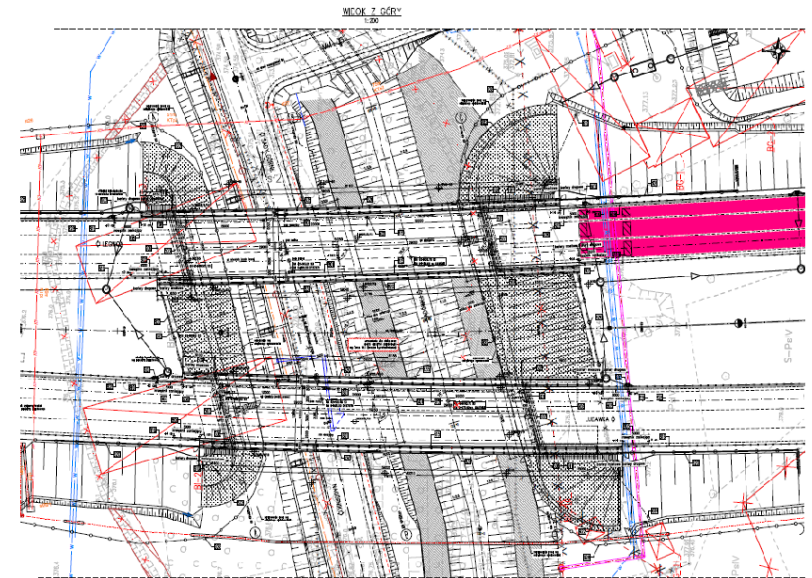
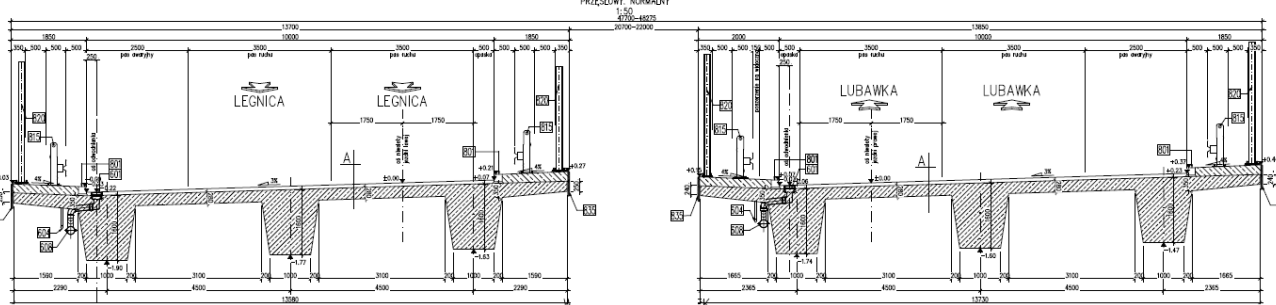

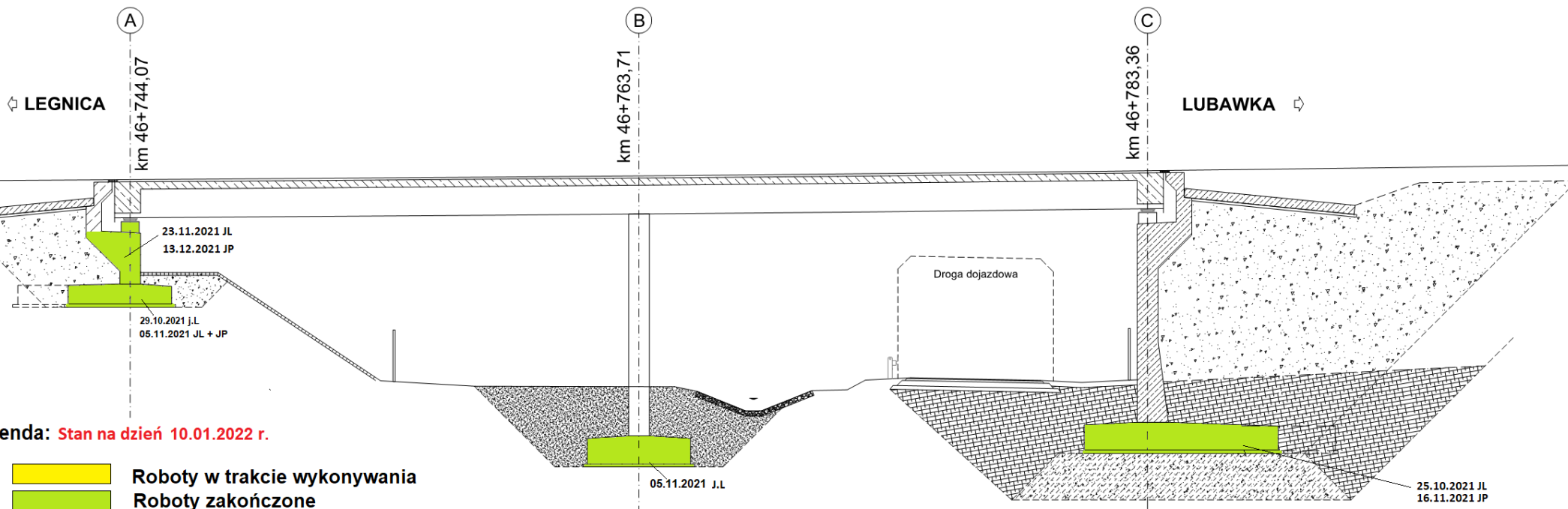

PG-29

km 46+743,46



Legenda: Stan na dzień 10.01.2022 r.

-  Roboty w trakcie wykonywania
-  Roboty zakończone

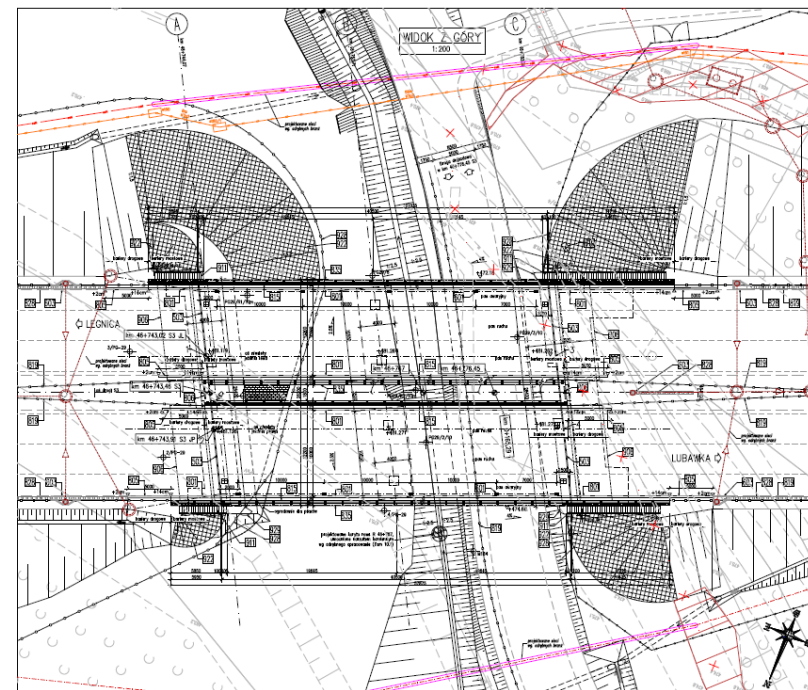
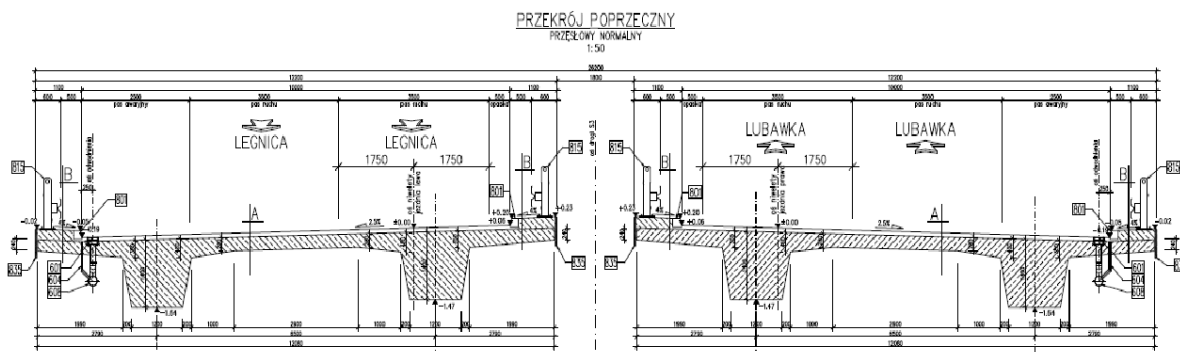

WS-31

km 47+568,12

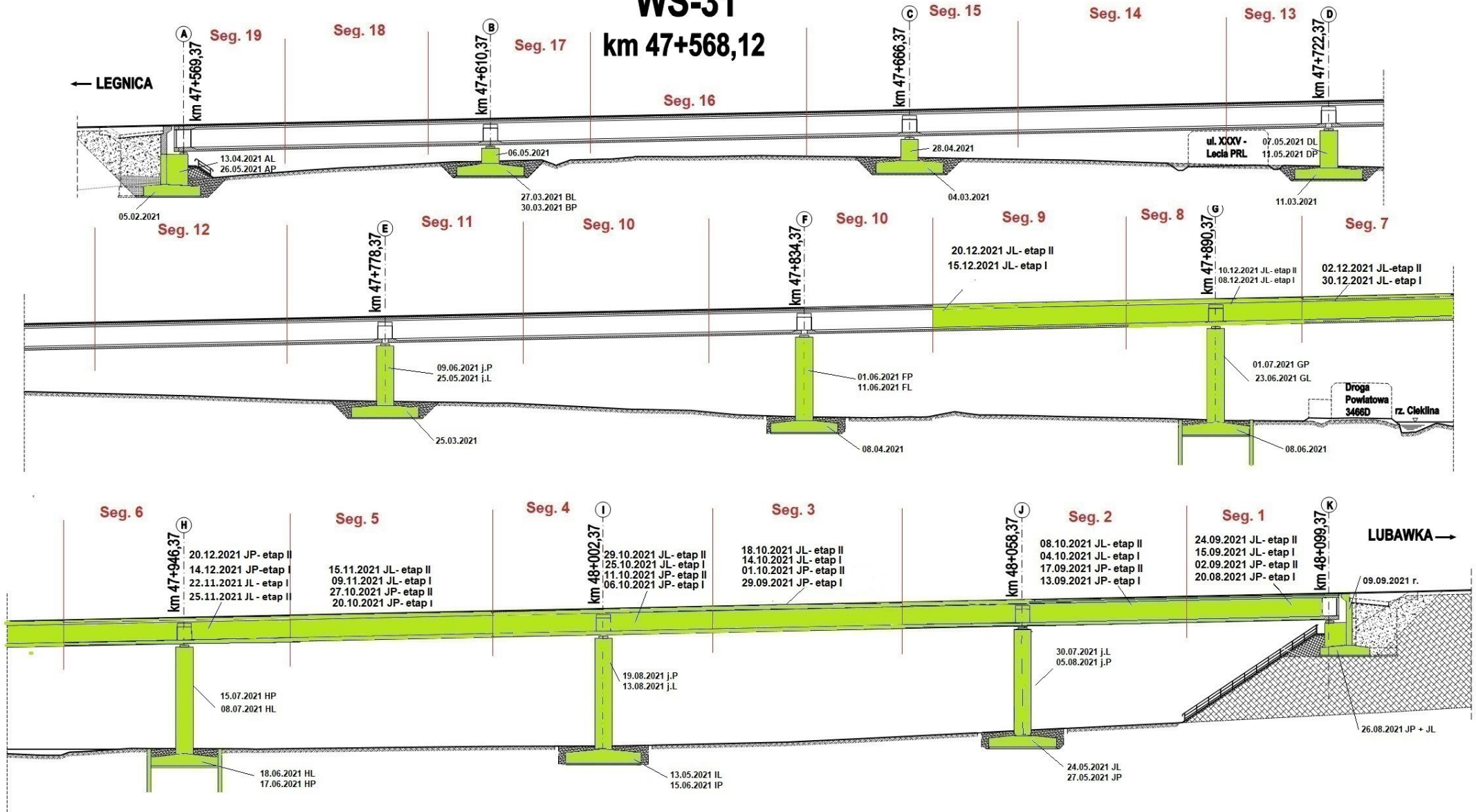

- Roboty w trakcie
- Roboty zakończone

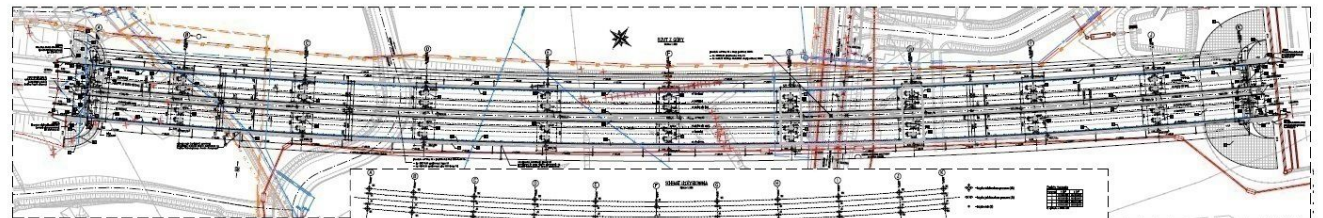
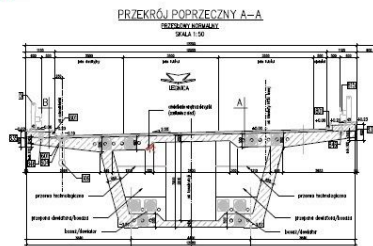

TUNEL TS-32

km 48+680,00 - 49+000,00

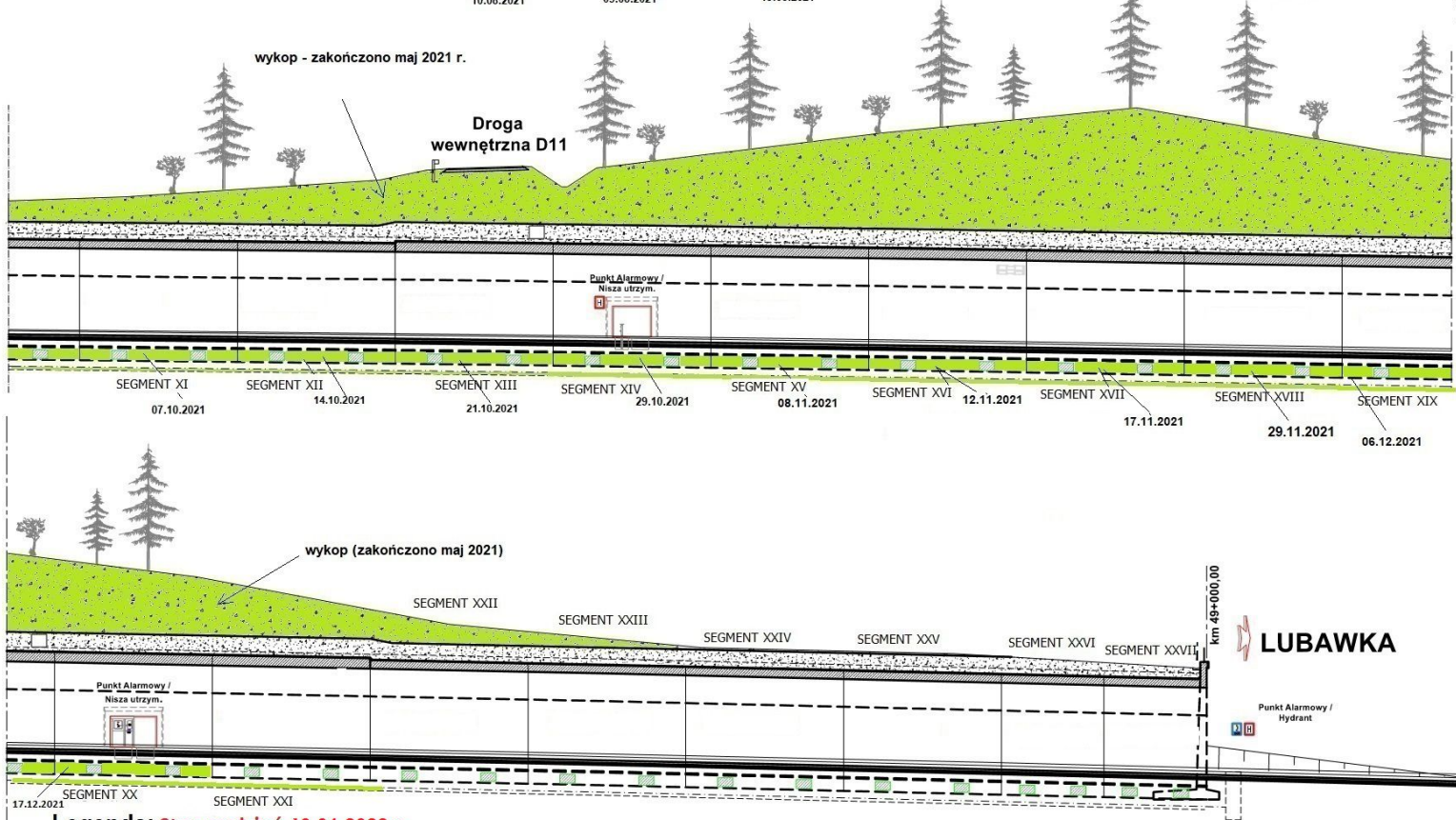
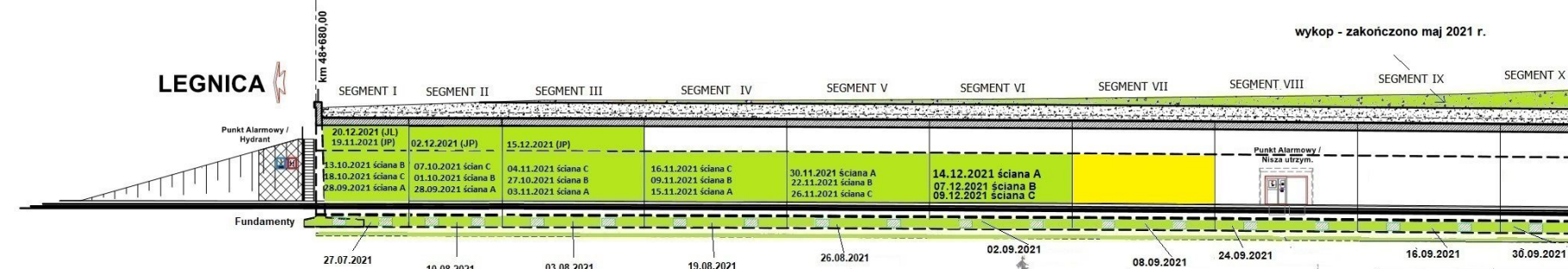

Legenda: Stan na dzień 10.01.2022 r.

- Roboty w trakcie wykonywania
- Roboty zakończone

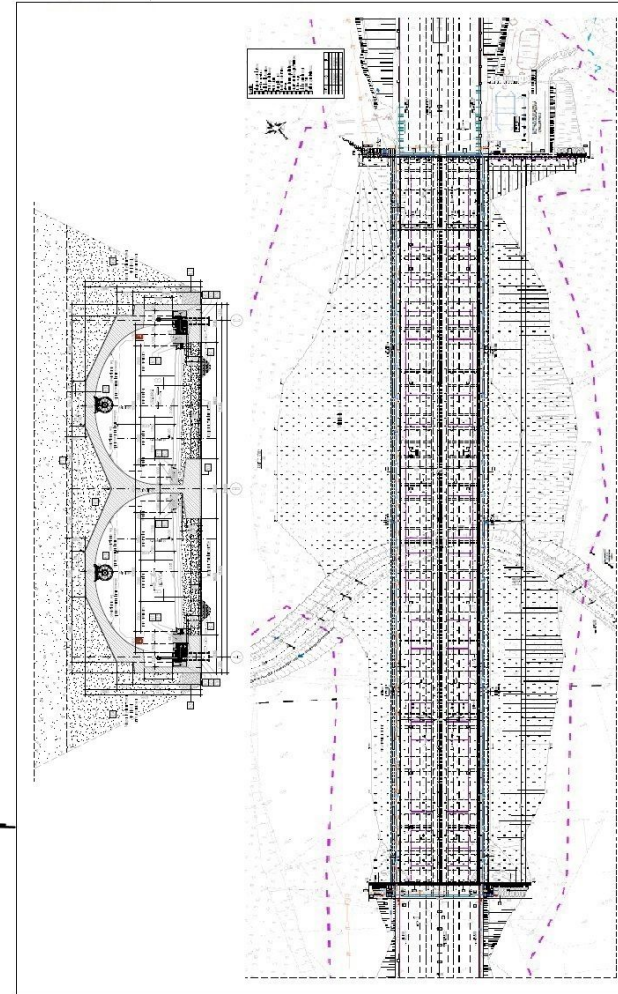

PG 10.1

km 50+097,00

LEGNICA ←

→ LUBAWKA

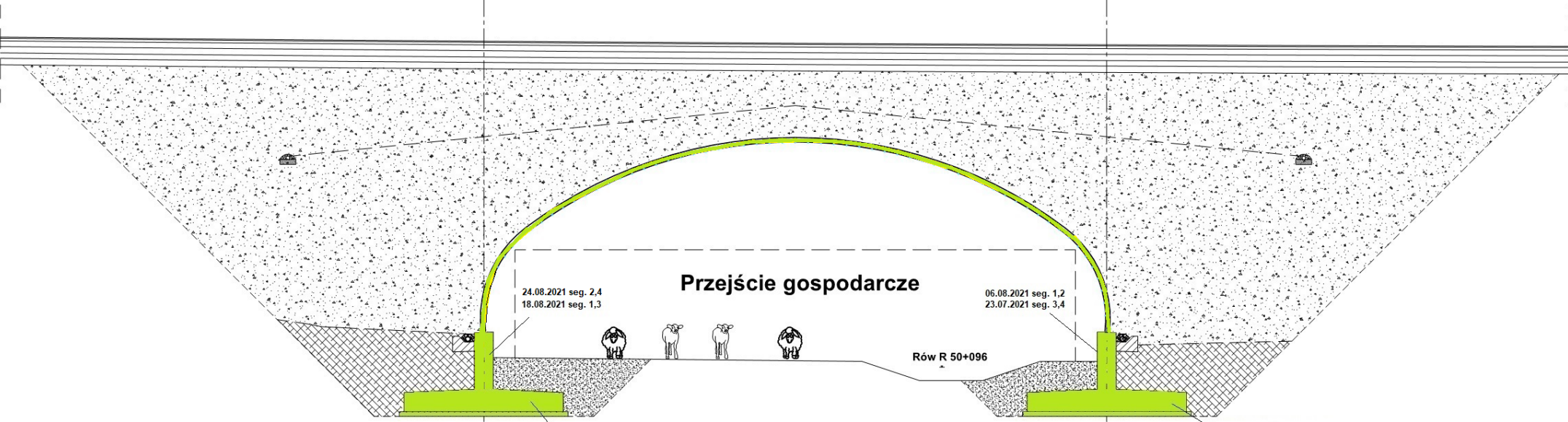

Legenda: Stan na dzień 10.01.2022 r.

- Roboty w trakcie wykonywania
- Roboty zakończone

05.07.2021 seg. 1,3
24.06.2021 seg. 2,4

06.08.2021 seg. 1,2
23.07.2021 seg. 3,4

08.07.2021 seg. 1,3
29.07.2021 seg. 2,4

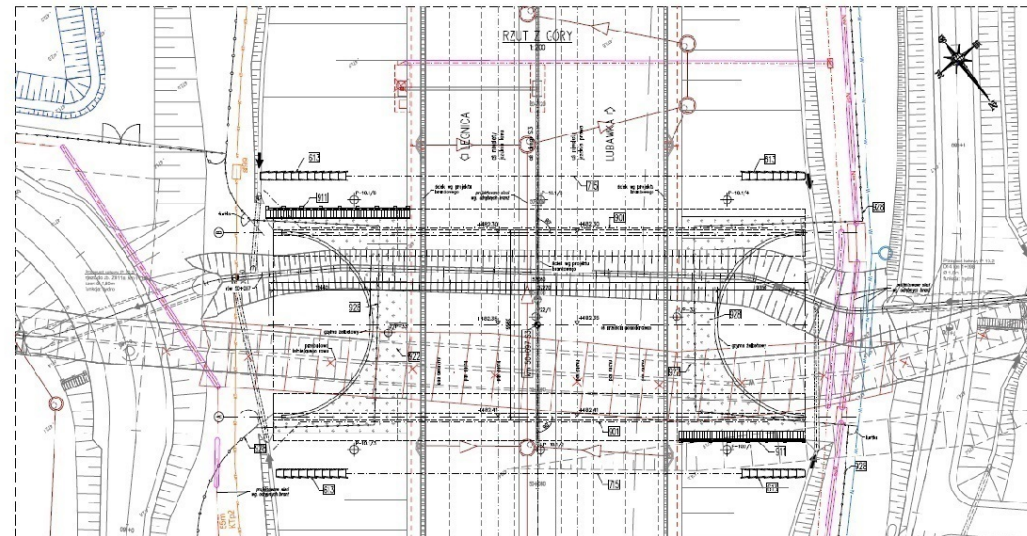
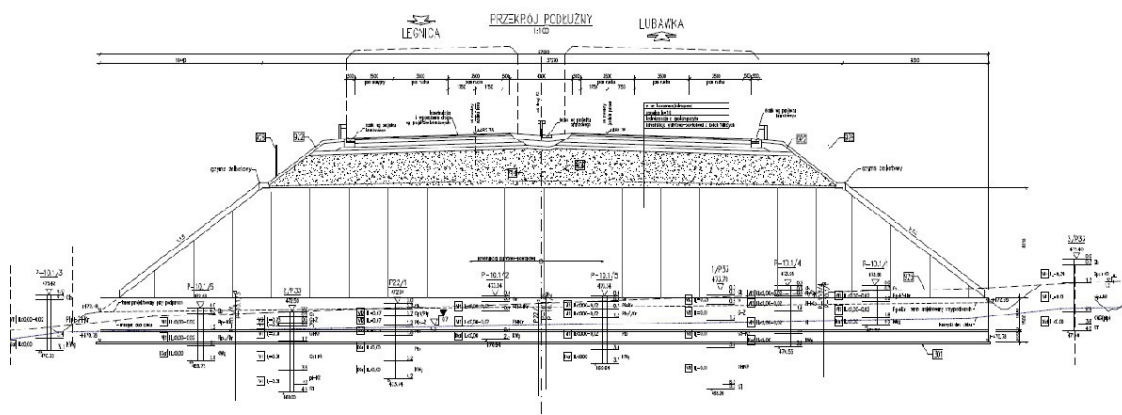

WS-33
km 49+530,70

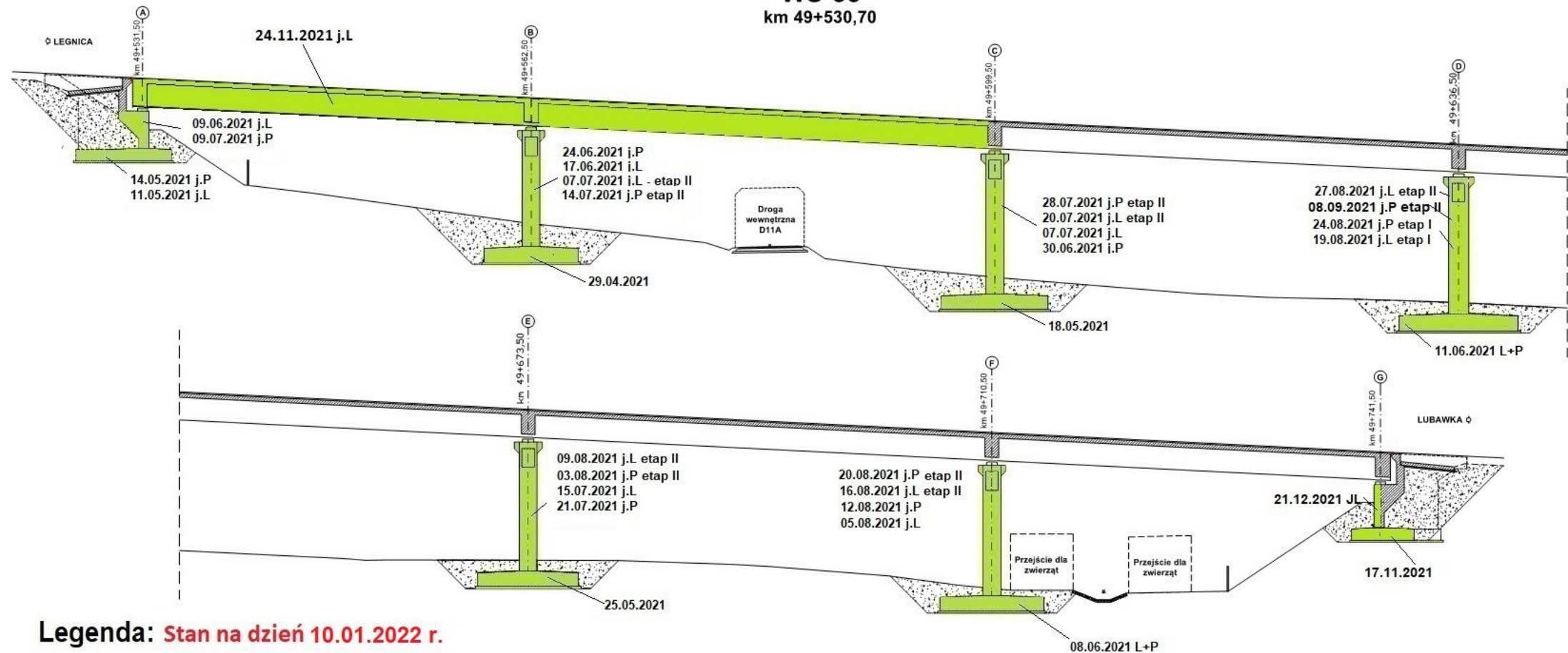

Legenda: Stan na dzień 10.01.2022 r.

- Roboty w trakcie wykonywania
- Roboty zakończone

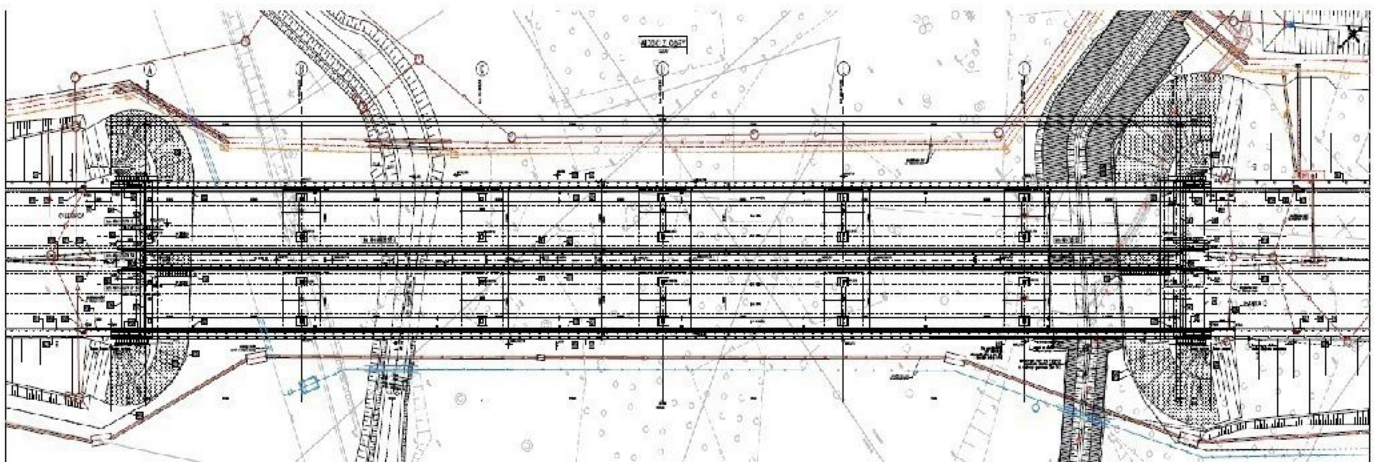
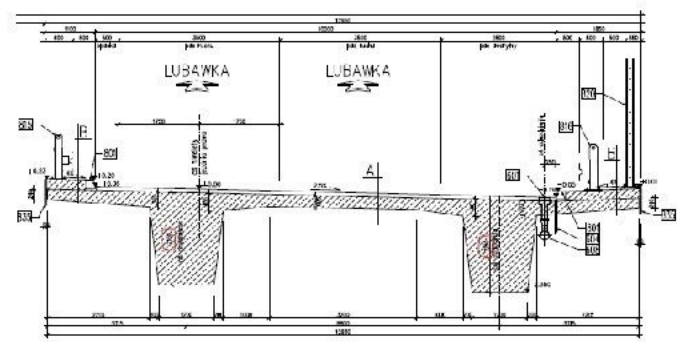

WD-34

km 50+661,15

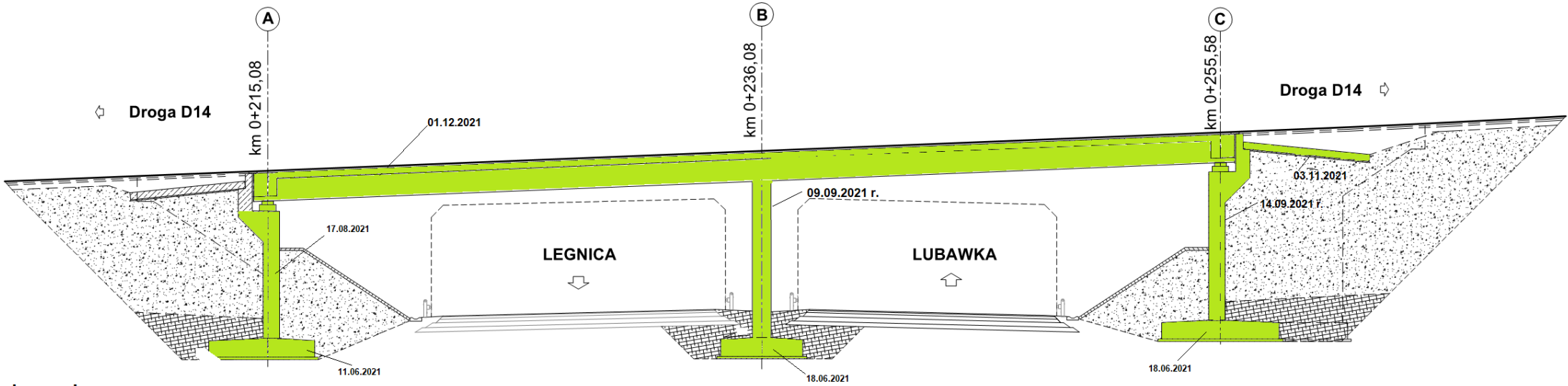

Legenda: Stan na dzień 10.01.2022 r.

- Roboty w trakcie wykonywania
- Roboty zakończone

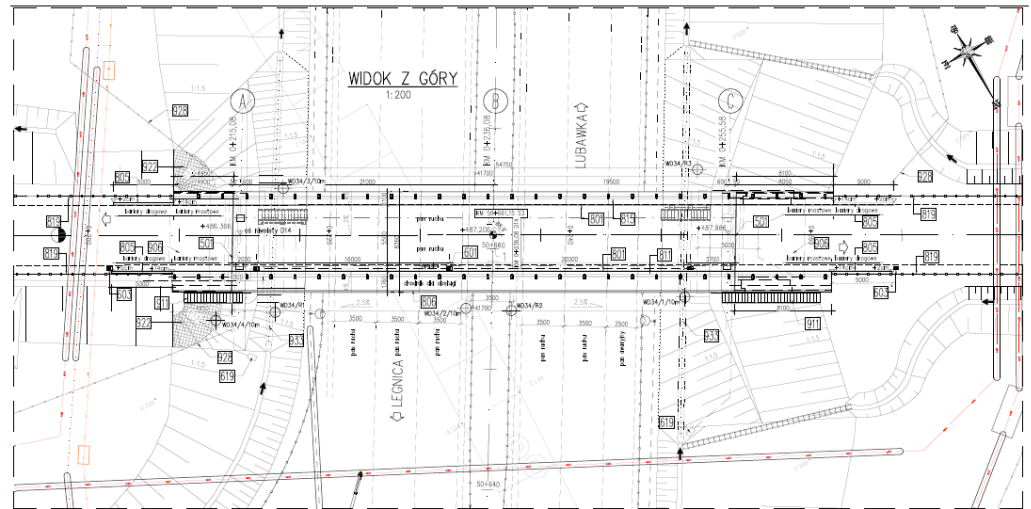
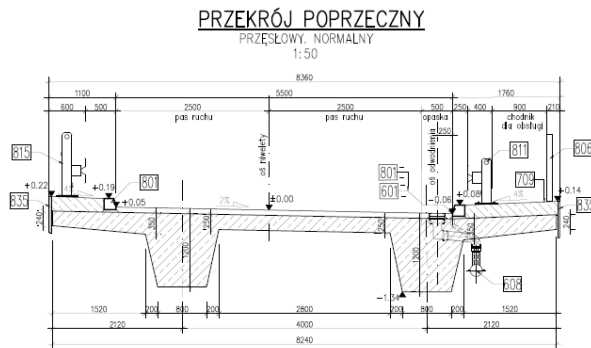

PG 11.1

km 51+249,00

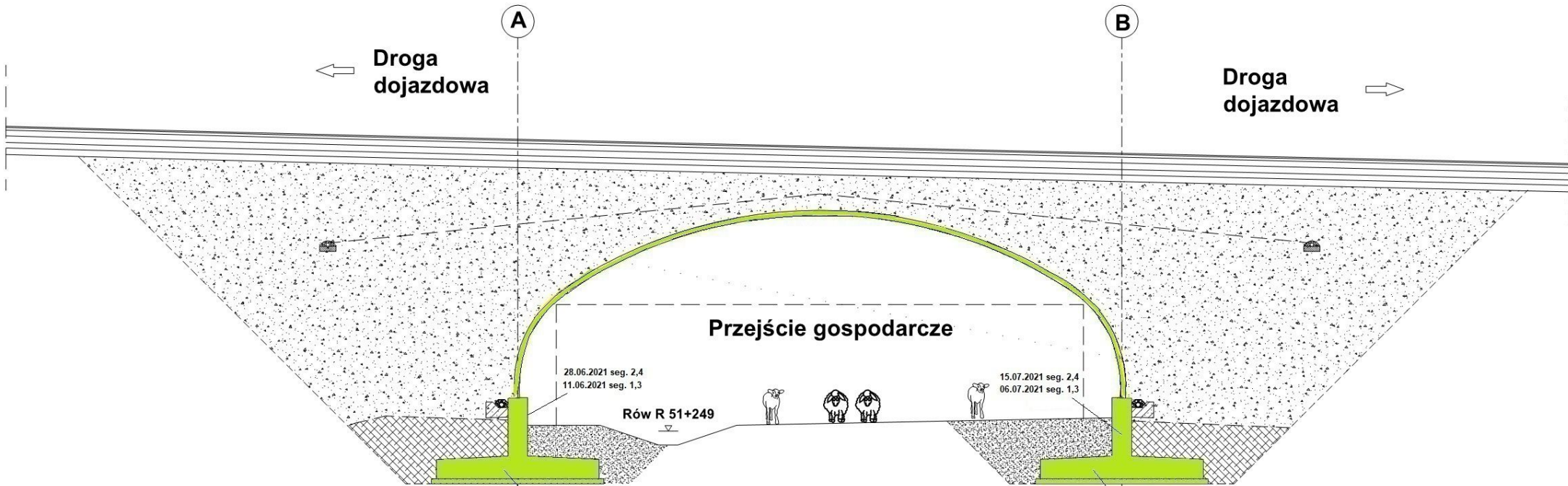

Legenda: Stan na dzień 31.12.2021 r.

- Roboty w trakcie wykonywania
- Roboty zakończone

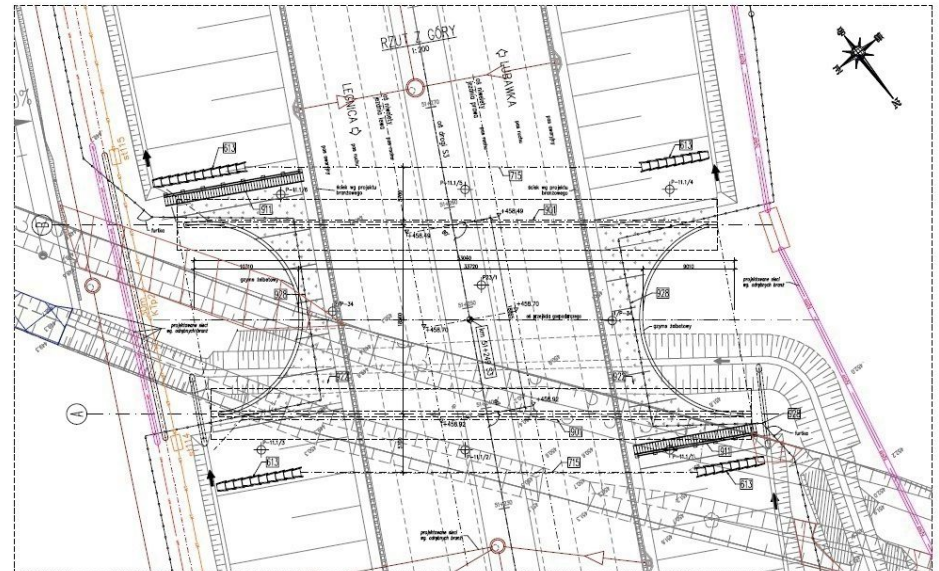
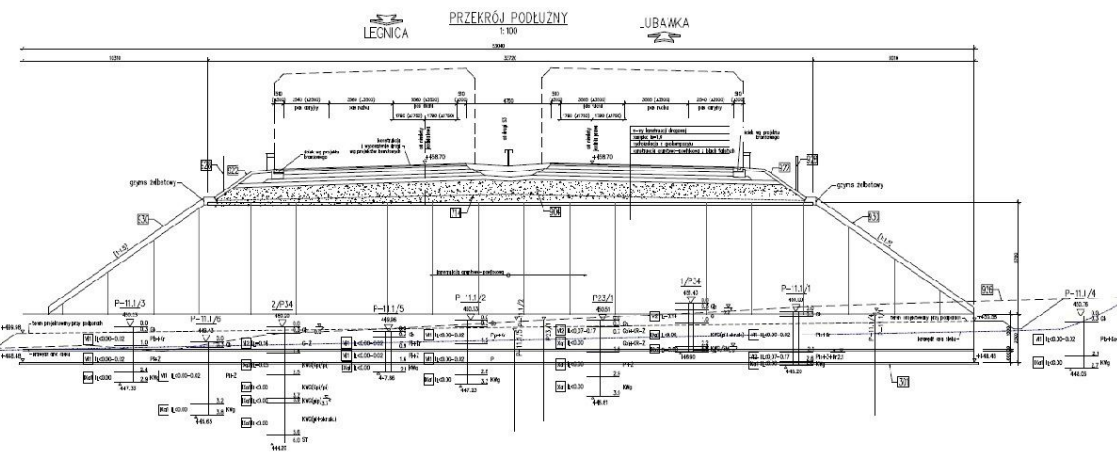

WS-35

km 51+508,81

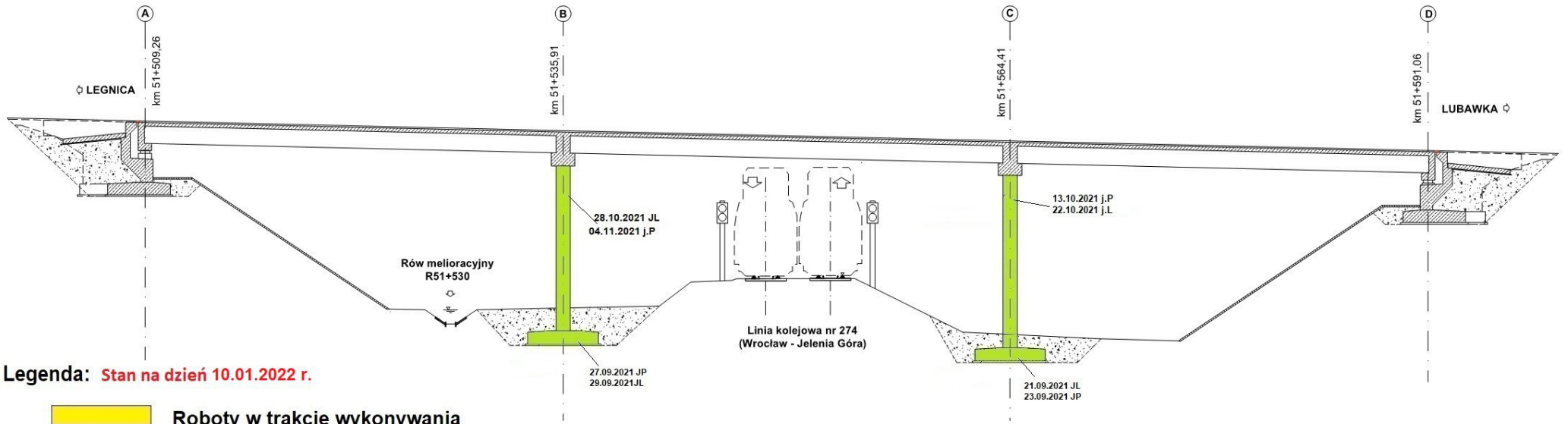

Legenda: Stan na dzień 10.01.2022 r.

- Roboty w trakcie wykonywania
- Roboty zakończone

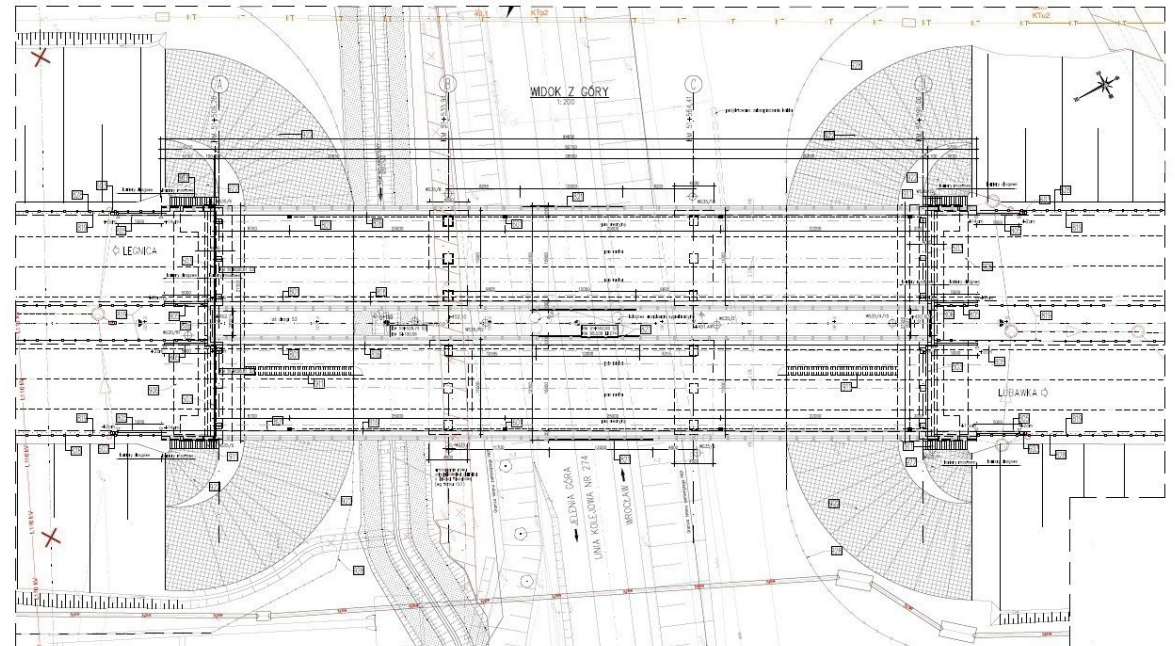
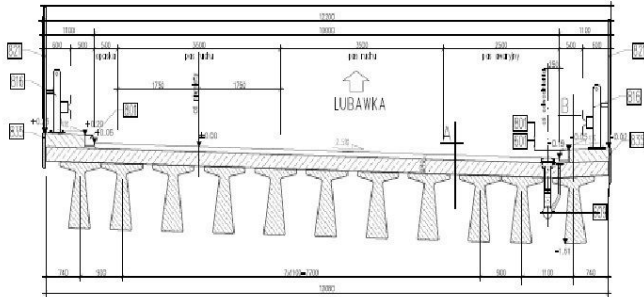

WS-36

km 51+780,95

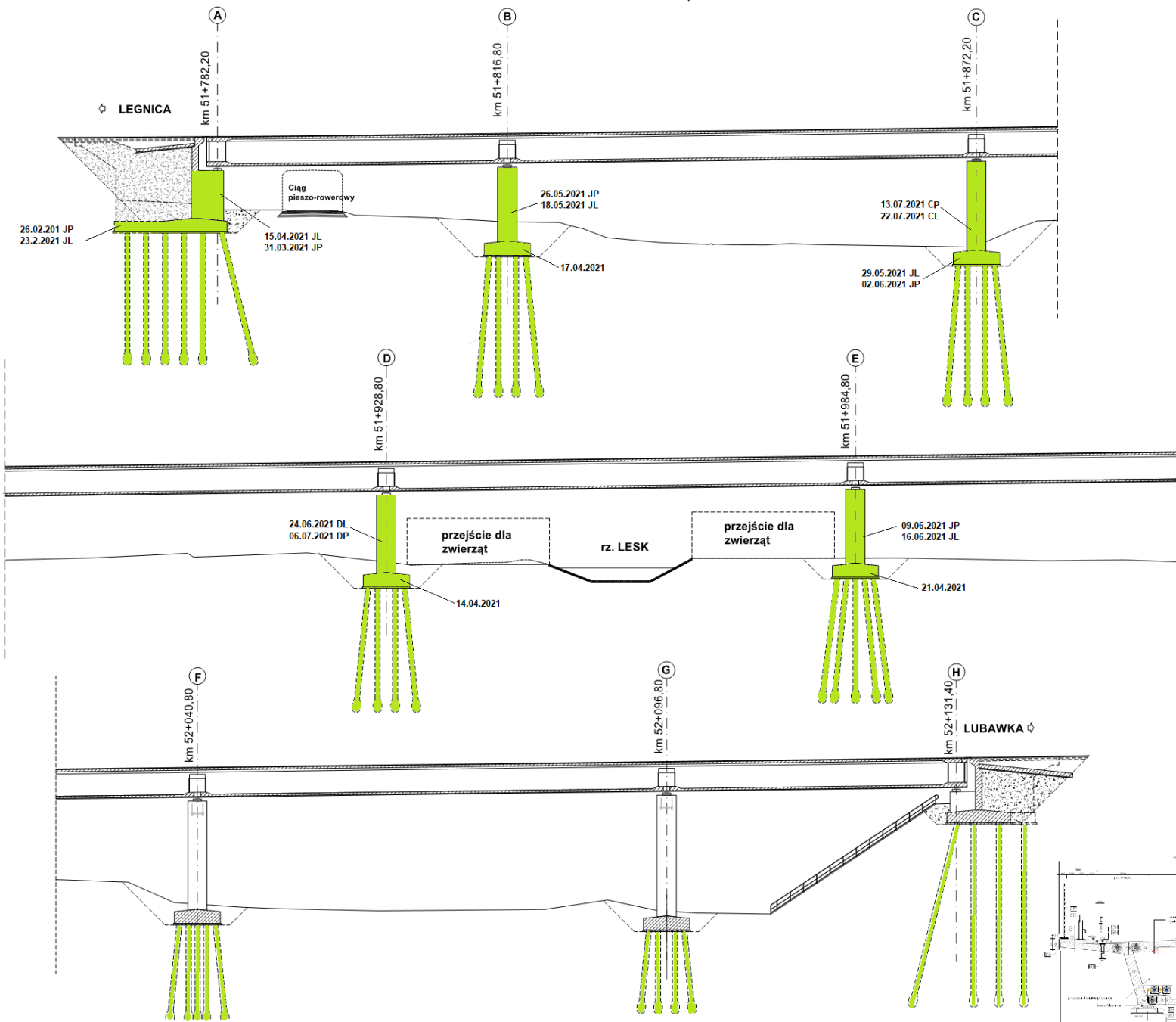

Legenda: Stan na dzień 10.01.2022

- Roboty w trakcie wykonywania
- Roboty zakończone

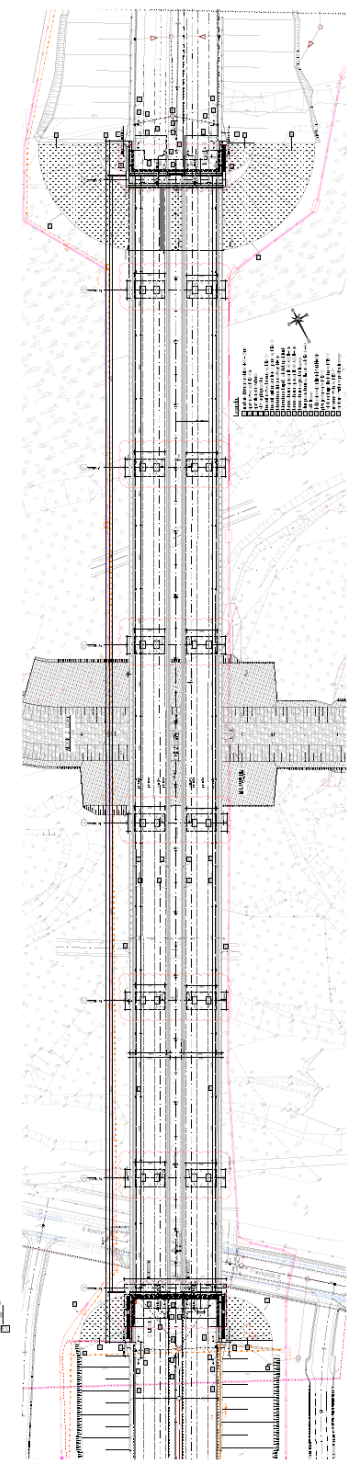
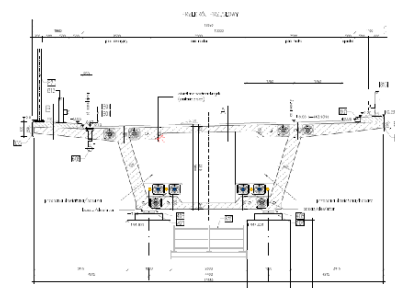

WS-37

km 52+994,25

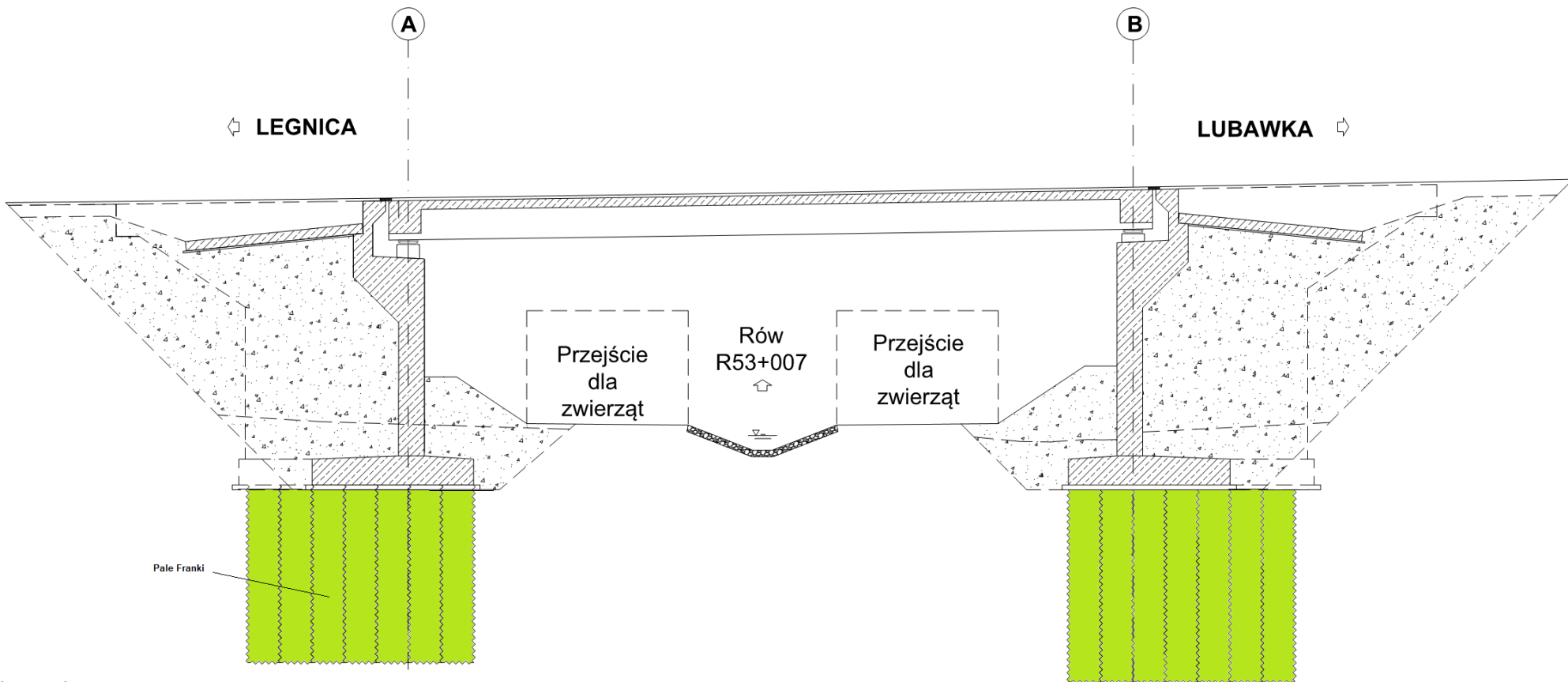

Legenda: Stan na dzień 10.01.2022 r.

- Roboty w trakcie wykonywania
- Roboty zakończone

PRZEKRÓJ POPRZECZNY
PRZEKROJE NORMALNY
1:50

